

USER GUIDE



KC200
KC200B



KC200
KC200B

COPYRIGHT

Evolis © November 2019. All rights reserved.

COPYRIGHT NOTICE

Users must observe the copyright regulations applicable in their country. This manual must not be photocopied, translated, reproduced, or transmitted, in whole or in part, for any reason and by any electronic or mechanical means whatsoever without the express written consent of Evolis.

All the information contained in this document is subject to change without prior notice.

Evolis cannot be held liable for any errors that may be found in this manual, or for any loss or damage arising accidentally or as a result of dissemination or use of this manual.

TRADEMARKS

Evolis Premium Suite® and Evolis High Trust® are trademarks of Evolis. All other trademarks belong to their respective holders.

WARRANTY

Please refer to the warranty notice supplied with your printer for the terms and conditions and limitations.

ENVIRONMENTAL INFORMATION

Evolis is committed to helping the environment by reducing the energy consumption of its products.

RECYCLING END-OF-LIFE PRODUCTS

Manufacturing the equipment that you have purchased required the extraction and use of natural resources. This equipment may contain materials that are hazardous to health and the environment.

To prevent the dispersal of such materials into our environment and to reduce pressure on our natural resources, we recommend that you use existing collection facilities. These systems will re-use or recycle most of the materials in your end-of-life equipment in an appropriate way.



The crossed-out dustbin symbol on your device is a reminder to use these facilities.

For further information on collection, re-use, or recycling systems, please contact your local or regional waste management organization.

Please do not hesitate to contact us to find out more by visiting our website at www.evolis.com or by emailing the following address: info@evolis.com.



KC200
KC200B

ABOUT YOUR NEW PRINTER

Using your new Evolis printer, you can create a wide variety of high-quality cards and personalized badges that can be printed and laminated in various thicknesses, colors, and styles. This printer uses consumables and accessories available from Evolis. For further details, visit our website at www.evolis.com.

WARRANTY REGISTRATION

Please register online at www.evolis.com to receive our special offers and general information.

Once on the website, click **Drivers and Support** then **Register your printer** and fill out all the fields, specifying in particular the model and serial number of your equipment found on your printer.

GETTING STARTED

The purpose of this guide is to support you, step by step, in discovering your printer and how it works. Please take some time to read it, to learn more about your printer and its features, and to save time during installation and use.

As with all Evolis products, a great deal of care has been taken over this manual. Should you find an error, however, please let us know by emailing us at info@evolis.com.

ICONS

The following icons are used in this manual to highlight important information:



Information providing further details about certain points in the main text.



Indicates that failing to take the recommended action is likely to damage your printer.



This symbol links to Evolis Print Center, accessible from your computer, which you can use to administer and manage your printer and change its settings.



Please read this manual carefully.



KC200
KC200B

1 – GETTING STARTED

UNPACKING

Your printer is supplied with several accessories that should be checked on receipt.
The list of accessories may vary depending on your location.

The printer is shipped in special packaging designed to prevent any damage in transit. If you notice any visible damage, please contact the shipping company and immediately inform your Evolis reseller, who will tell you the procedure to follow.

Evolis takes great care over the quality of its packaging and we ask that you keep this packaging somewhere clean and dry.



You will be asked for the full original packaging (outer box, inner wedges, and protective bags) in the event that the printer is returned. If the printer is returned without its original packaging and the components are damaged in transit, these components will no longer be covered by the warranty. A charge will be made for new packaging to reship the printer.

Accessories supplied with your printer:

- Power supply unit- CWT type KPL-065M-VI
- Mains power cable
- USB cable
- Installation, documentation, and software CD-ROM
- Starter cleaning kit
- Quick installation guide



If any of these components are missing, please contact your Evolis reseller.
Use only the power supply unit provided with your Evolis printer.
CWT type KPL-065M-VI.
Use only the USB cable supplied with your Evolis printer.



The Evolis printer must be placed in a dry location, protected from dust and drafts, but well-ventilated.
Please ensure you keep your printer on a flat, solid surface able to bear its weight.



KC200
KC200B

DESCRIPTION OF THE PRINTER AND ITS FUNCTIONS

KC200

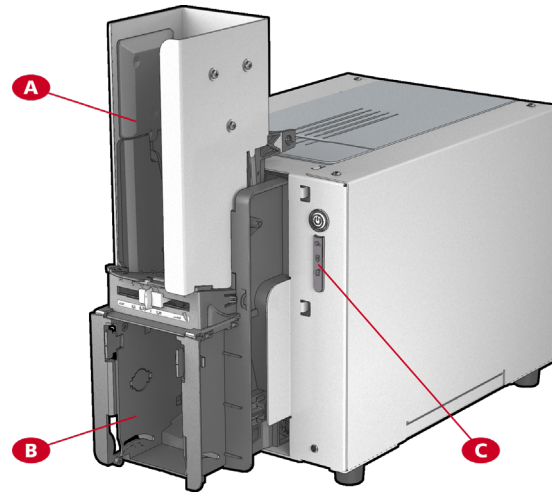

- A - Card feeder
- B - Card output
- C - Control panel
- D - USB port (type A)
- E - USB port (type B)

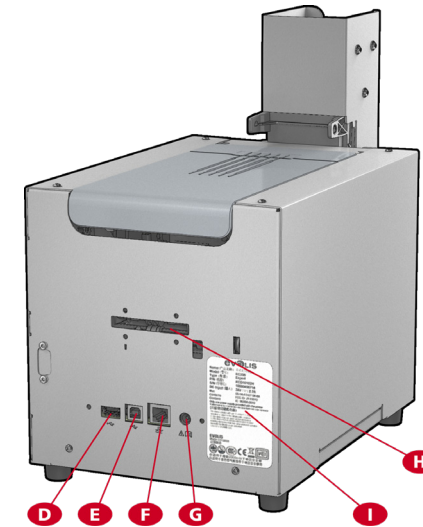

- F - Ethernet port
- G - Power cable socket
- H - Ejector slot
- I - Serial number label



KC200
KC200B

DESCRIPTION OF THE PRINTER AND ITS FUNCTIONS

KC200B

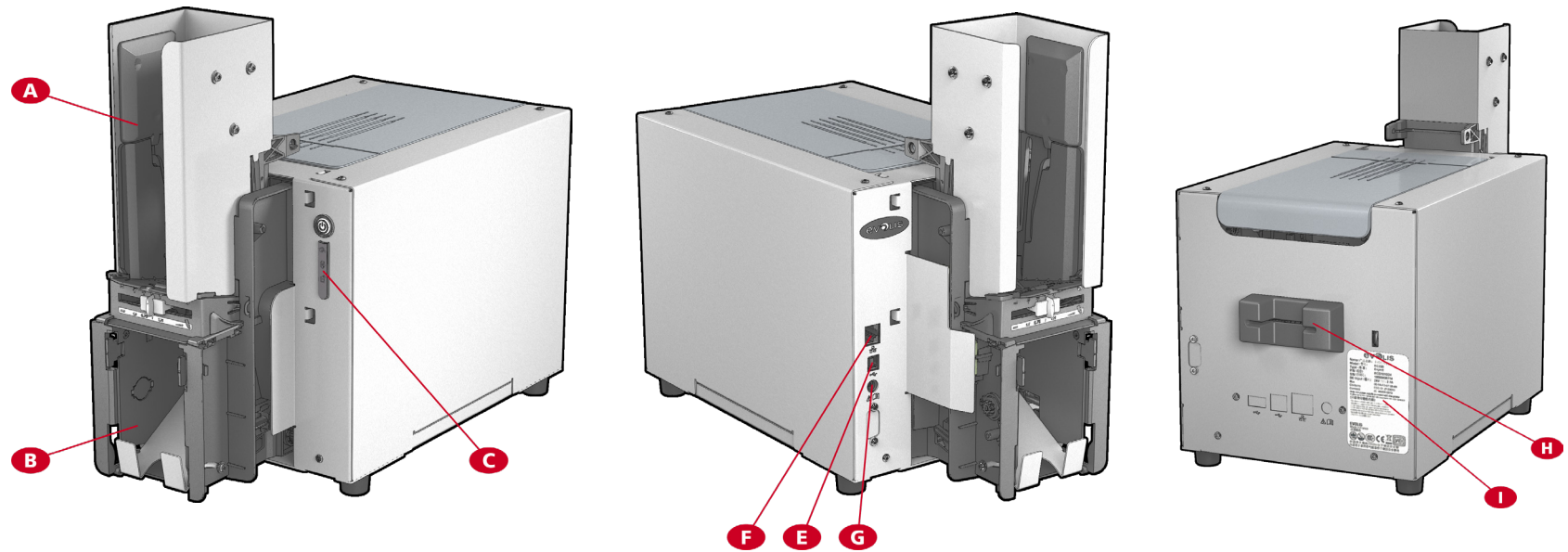

- A - Card feeder
- B - Reject hopper
- C - Control panel
- E - USB port (type B)

- F - Ethernet port
- G - Power cable socket
- H - Bezel (card insert and output)
- I - Serial number label



KC200
KC200B

DESCRIPTION OF THE PRINTER AND ITS FUNCTIONS

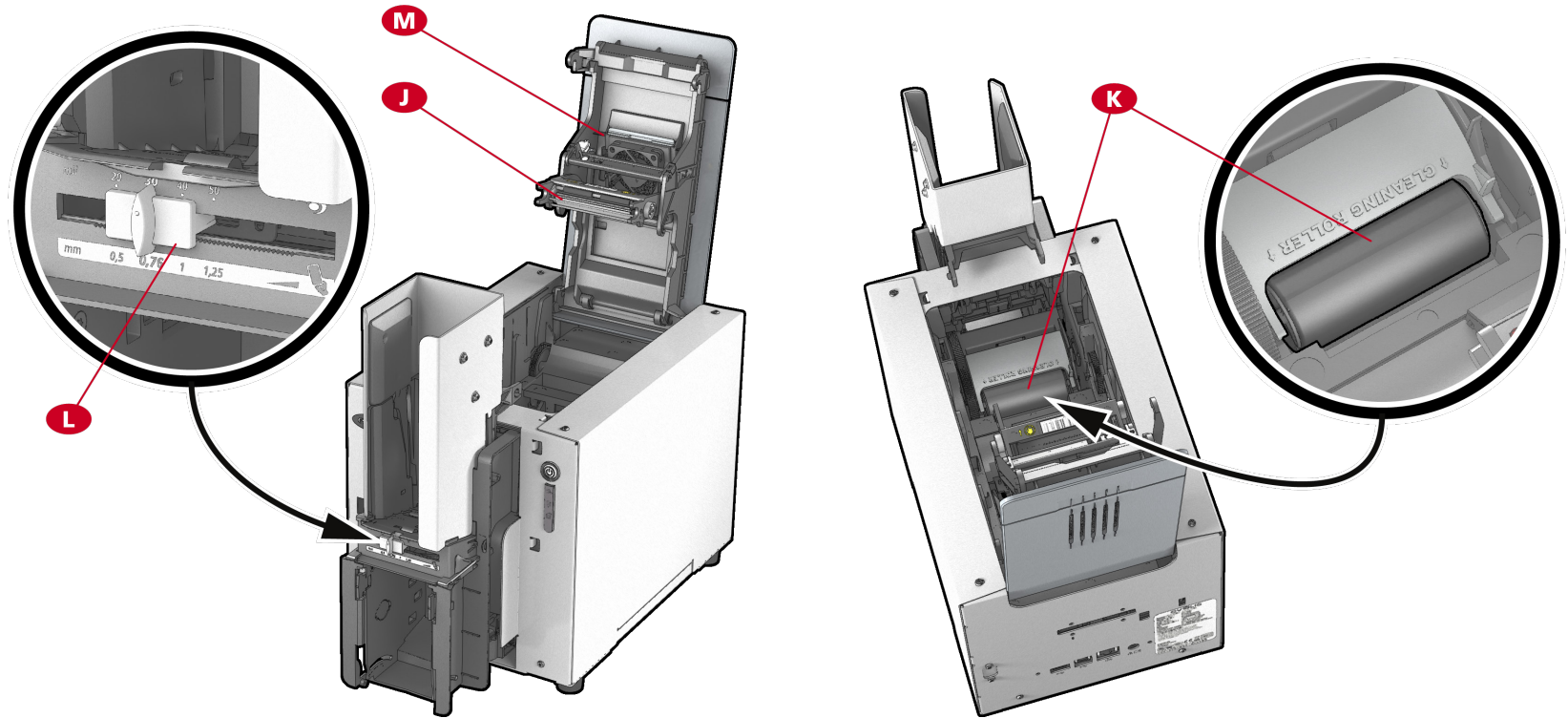

J - Thermal print head

K - Cleaning roller

L - Card thickness adjustment gauge

M - Dust filter



KC200
KC200B

INSTALLATION IN A TERMINAL

Physical attachment

The KC200/KC200B printers can be attached to the terminal using screws.

To do so:

- 1 Unscrew the 2 screws at the top of each side panel. Set the side panels down.
- 2 Remove the 4 rivet feet from the bottom plate by pressing on them.
- 3 There are slotted holes (5 on each side) on the bottom plate to enable you to attach the printer to the terminal.

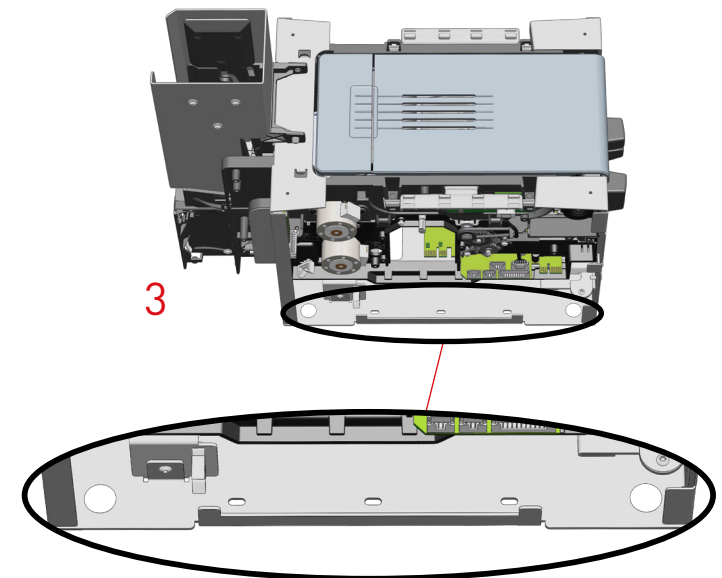
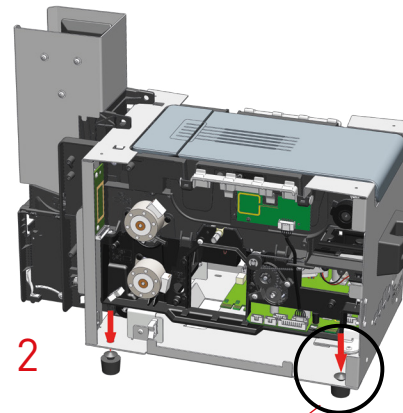
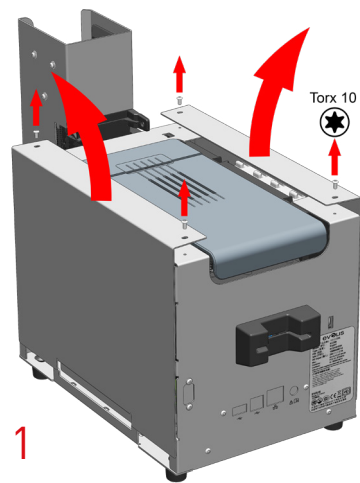
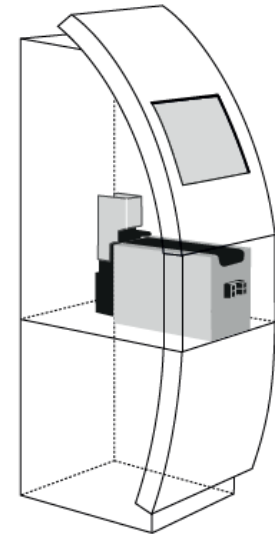



KC200
KC200B

INSTALLATION IN A TERMINAL

Connecting the printer



The printer must be connected to a properly protected and grounded electrical system.

FI: Laite on liitettävä suojamaadoitus koskettimilla varustettuun pistorasiaan.

NO: Apparatet må tilkoples jordet stikkontakt.

SE: Apparaten skall anslutas till jordat uttag.

DK: Printerens skal tilsluttes til en korrekt beskyttet og jordforbundet el-installtion.

To do so:

- Connect the power cable to the power supply unit, then plug the power cable jack into the printer.
- Next, connect the power cable plug to a grounded power socket outside of the terminal.
- The printer is powered on: the control panel lights up indicating that the printer is working properly. If the control panel does not light up, then either the installation has not been carried out correctly or the printer is not working properly. Check the installation.

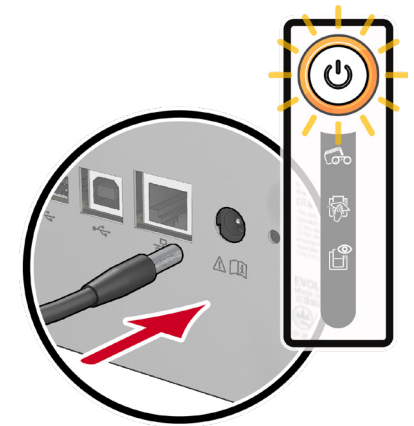



KC200
KC200B

Ribbons

Evolis original High Trust® ribbons optimize the operation of your printer and avoid causing damage to it. The use of third-party ribbons may damage your printer and will void the manufacturer's warranty for the printer.

For optimum print quality, Evolis recommends that the printer is fully cleaned every time the ribbon is changed. See the Servicing chapter of this manual.

Fitting the ribbon



The printer automatically recognizes the ribbon inserted.

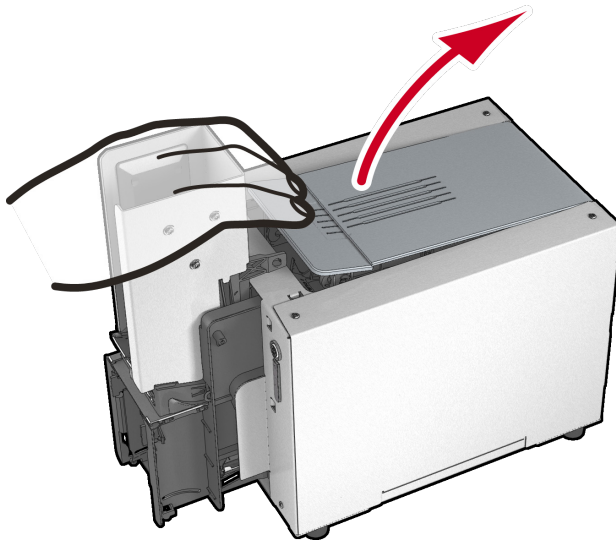

Open the cover.

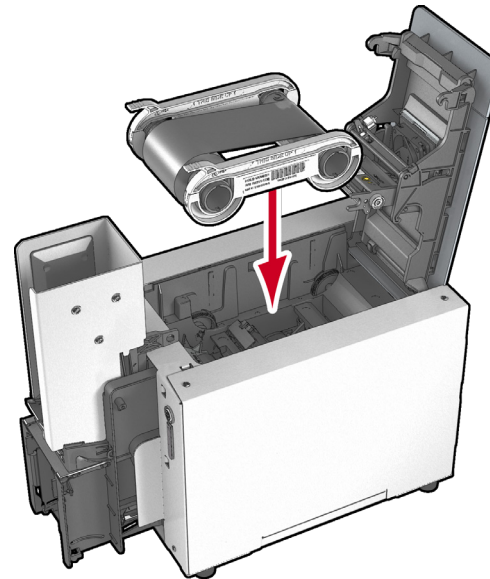

Insert the ribbon as shown.

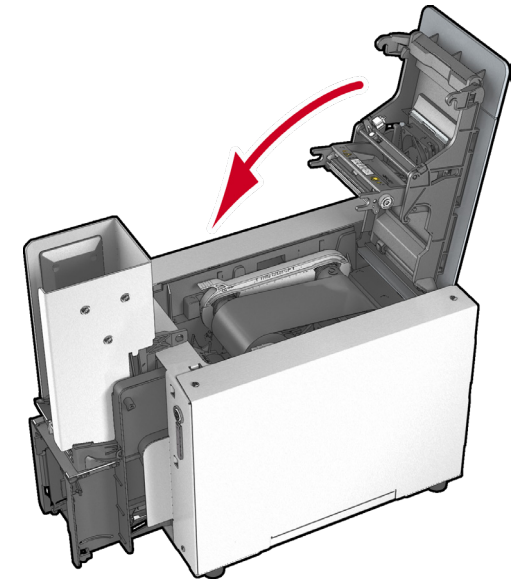

Close the cover and press until you hear a click.



KC200
KC200B

Cards



For optimum quality, the cards used must be ISO 7810 certified.
Use only the card types recommended by Evolis.
Avoid touching the printable surface of the cards in order to preserve print quality.
Do not use cards that have been damaged, folded, embossed, or dropped on the floor.
Cards may be stuck together due to static electricity – avoid touching the card surface when separating them.

Storing new cards

Keep your cards protected from dust in their original packaging.

Loading the cards

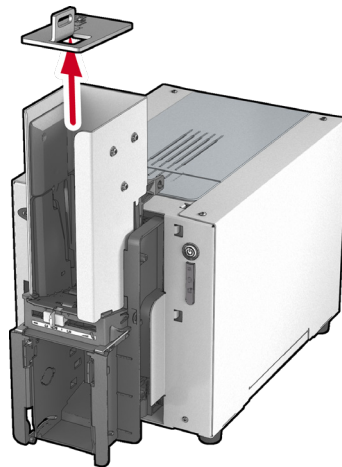

Remove the weight
from the feeder.

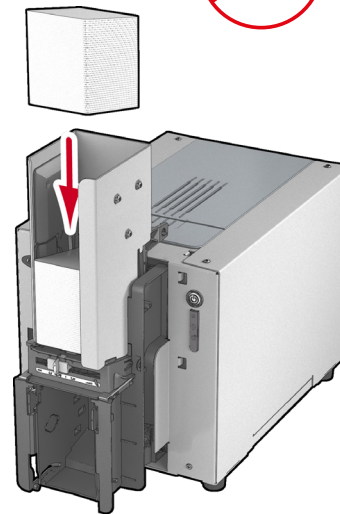

Insert the cards, 200 cards maximum
with 0.76 mm thickness for KC200/KC200B.
Hold and insert the cards as shown
in the diagram.

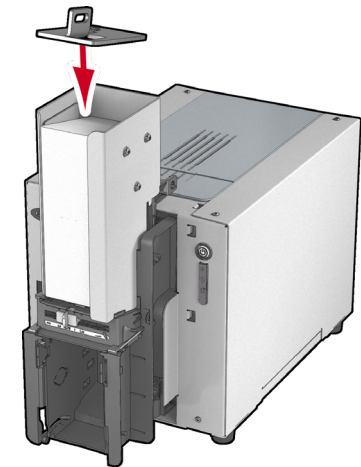
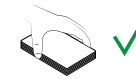

Put the weight back on
the inserted cards.



KC200
KC200B

Removing printed cards

Once the print cycle is complete, the printed and/or encoded card is issued into the output hopper of the terminal. For the KC200B, it is returned directly through the bezel.



Adjusting the card thickness

The printer is equipped with a manual card thickness adjustment system, which can be reached at the printer feeder. The factory setting for card thickness is 0.76 mm.

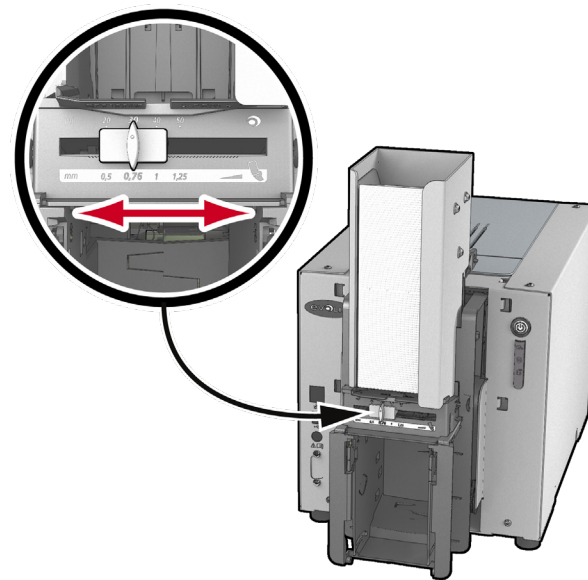



KC200
KC200B

2 - SERVICING

GENERAL WARRANTY INFORMATION

Please comply with the instructions given below to ensure that your printer runs satisfactorily.

Keep your warranty cover!



The manufacturer's warranty is subject to strict adherence to the routine servicing and maintenance instructions, and in particular the printer cleaning cycles.

Any failure to follow the servicing procedures described in this chapter will void the print head warranty.

Any failure to follow the servicing procedures described in this chapter will void the print head warranty.

Evolis declines any liability where there has been a failure to carry out required maintenance on the printer.

The print head is a wear part and an extremely sensitive component of the printer. Its useful life can be seriously curtailed by the presence of dust, liquids or solids in the printer's immediate environment, on the print head or on the cards. The user must take all necessary precautions to insert into the printer only clean, dust-free cards that are free of foreign bodies.

The frequency and quality of cleaning are decisive factors enabling users to extend the print head's useful life and to ensure excellent print quality. Particular care must therefore be taken with cleaning. The user must comply with the servicing and maintenance instructions given in this section.

In addition, the use of Evolis brand ribbons (Evolis High Trust®) also ensures that your equipment operates properly. The use of non-Evolis approved ribbons can therefore affect the quality and reliability of printing jobs, lead to poor quality printing, and even affect the operation of the printer. The manufacturer's warranty does not cover physical damage or quality problems caused by using non-Evolis approved ribbons.

Evolis supplies servicing items and consumables. You can find them on the website www.evolis.com.



KC200
KC200B

ROUTINE PRINTER CLEANING (SN ≥ 10000828147)

For printers with SN serial numbers greater than or equal to 10000828147, please follow the cleaning procedure below.

Printer servicing



The print head warranty is directly linked to routine cleaning of your printer.
If you do not carry out this cleaning at the required times, the print head warranty will cease to be valid.



Recommended cleaning cycle: whenever the ribbon is changed.
Mandatory cleaning cycle: when the cleaning warning is triggered.
Servicing accessory: adhesive cleaning card.



Your printer is fitted with a cleaning warning system, which is triggered after a certain number of cards have been inserted. You should proceed with the routine cleaning of your printer as soon as the warning is triggered. If you continue to run the printer despite the warning and if the warning light remains lit, the print head warranty will be automatically voided because of failure to comply with contractual maintenance obligations.

Printer cleaning required after:
(warning light flashing)

1000 cards

Number of cards remaining before
warranty voided:
(warning light flashing)

200 cards

Warranty invalid after:
(warning light steady)

1200 cards



KC200
KC200B

Follow the procedure below to validate your routine cleaning:

Repeatedly passing the adhesive card through the printer cleans the cleaning roller in order to preserve print quality and increase the life of the print head.

- 1 Remove the weight and remove all cards from the feeder.
- 2 Remove the ribbon from the printer.
- 3 Set the card thickness gauge to MAX position.
- 4 Close the cover again.

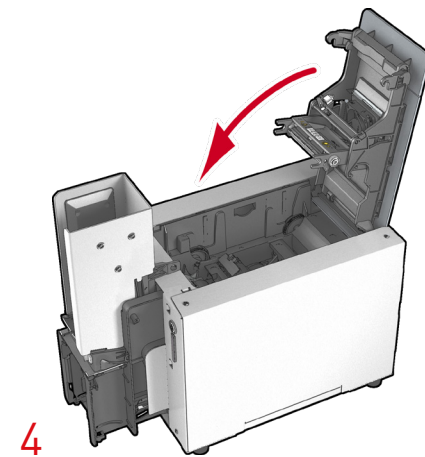
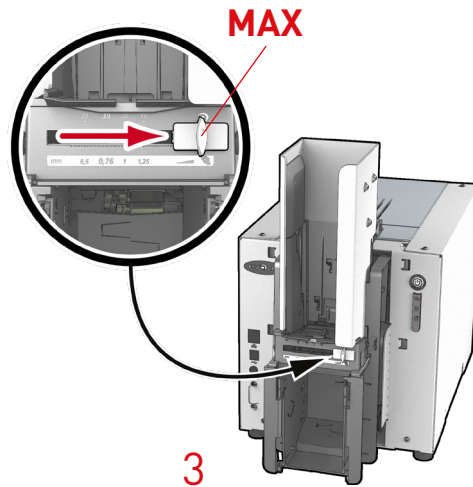
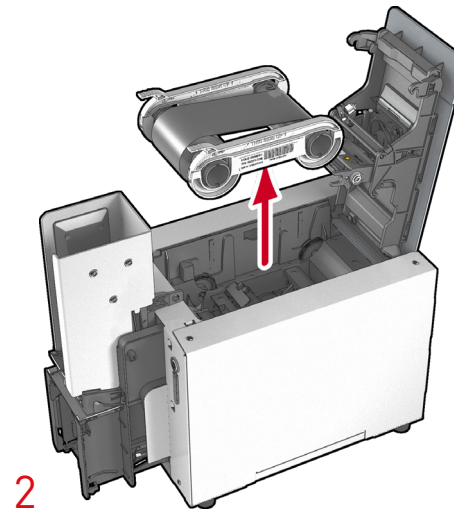
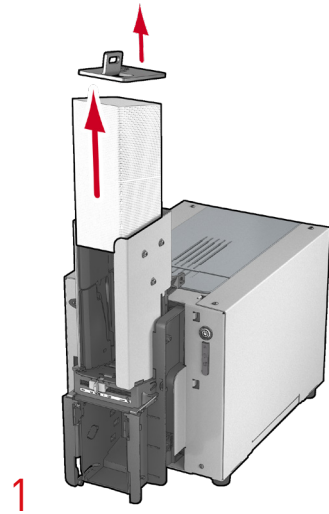



KC200
KC200B

- 5 Remove the cassette at feeder level.
- 6 Double-click the control button on the control panel before inserting the cleaning card.
- 7 Remove the film from the adhesive card (1) and insert the cleaning card into the feeder as shown, adhesive side up (2). Cleaning starts.
- 8 Remove the cleaning card.
- 9 Replace the cassette at feeder level.

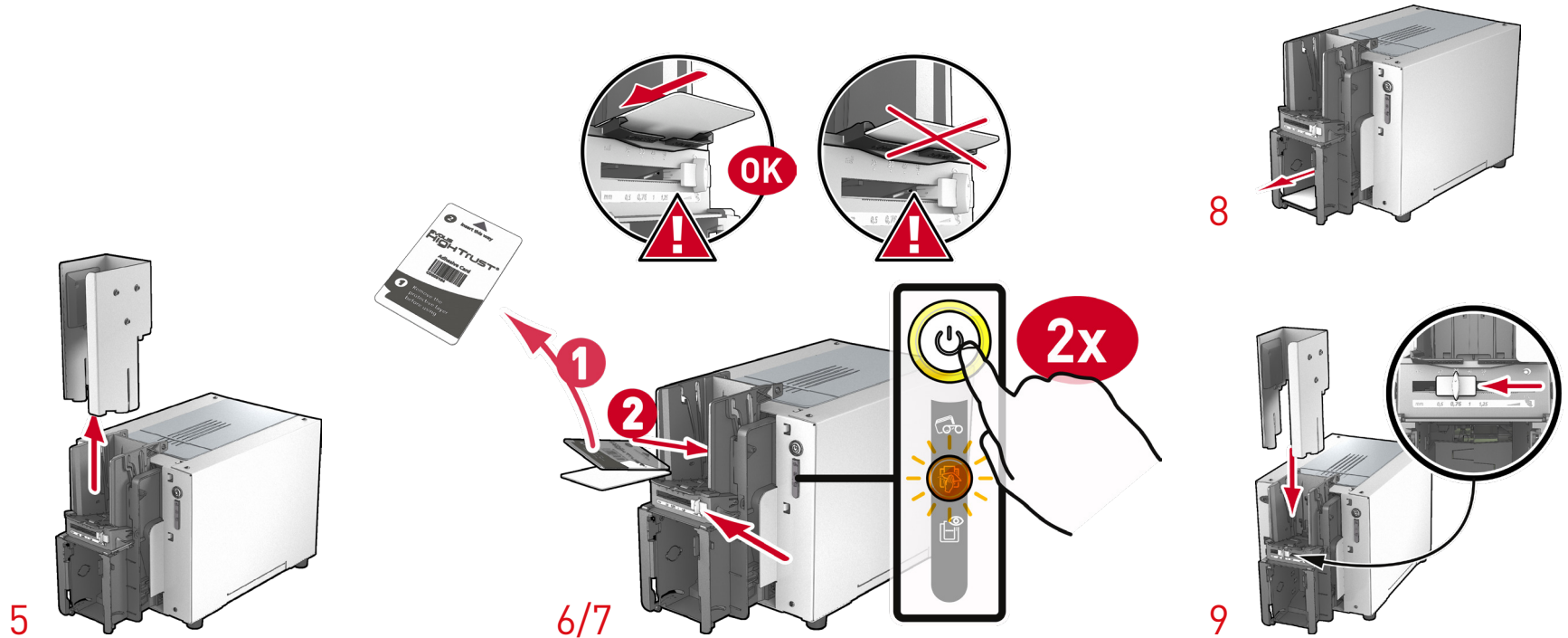

Routine cleaning may also be launched from the Evolis Print Center by clicking on "Start cleaning."



Before using your printer, remember to reset the gauge to the desired card thickness.



KC200
KC200B

Servicing the Print Head



Recommended cleaning cycle: whenever the ribbon is changed.
Servicing accessory: special cotton swab impregnated with isopropyl alcohol or cleaning pen.

To maintain the original print quality and to absorb excess ink on the print head, we recommend that you clean the print head regularly (at each ribbon change and periodic cleaning) using the cotton swabs provided by Evolis. You must also protect the print head and its components from any electrostatic discharge.



Follow the cleaning cycles scrupulously.
Avoid any contact between the print head and any metal or sharp objects.
Avoid touching the print head directly with your fingers, as this could affect print quality or permanently damage the print head.

Follow the procedure below:

- 1 Take an Evolis cotton swab and press the middle of the tube until the end of the swab is soaked in alcohol.
- 2 Open the cover and locate the print head.
- 3 Gently rub the swab from left to right along the print head for a few seconds.
- 4 Close the cover.

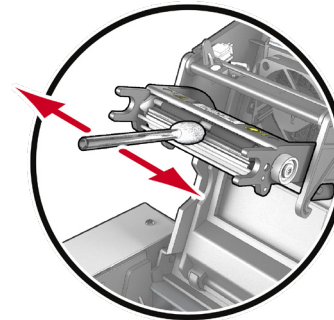

Wait for 2 minutes after cleaning before using your printer.



KC200
KC200B

ADVANCED CLEANING (SN≥10000828147)

For even more thorough cleaning, we recommend advanced cleaning every 5 routine cleaning cycles.

To do this, Evolis provides an Evolis High Trust® maintenance kit consisting of 2 adhesive cards, 2 pre-soaked "T" shaped cards, a cleaning pen, and a box of wipes. The "T" shaped cleaning card is used to clean **the transport rollers and the magnetic encoder head**. Please go through the following steps to validate advanced cleaning.

Printer servicing



Recommended cleaning cycle: every 5 routine cleaning cycles.
Servicing accessory: pre-soaked "T" shaped card and adhesive card.

Follow the procedure below:

- 1 Open the printer cover.
- 2 Remove the ribbon.
- 3 Close the cover and check it has clicked shut.

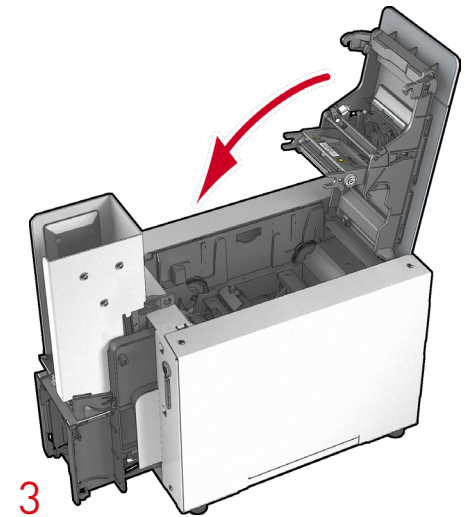
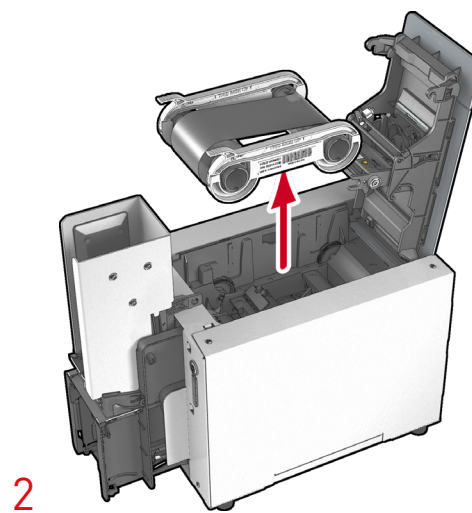
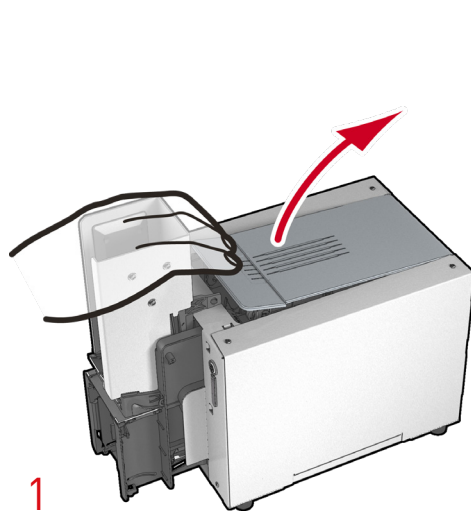



- 4 Using the gauge, set the card thickness to the MAX position.
- 5 Remove the cards from the feeder if necessary.
- 6 Remove the feeder cassette.

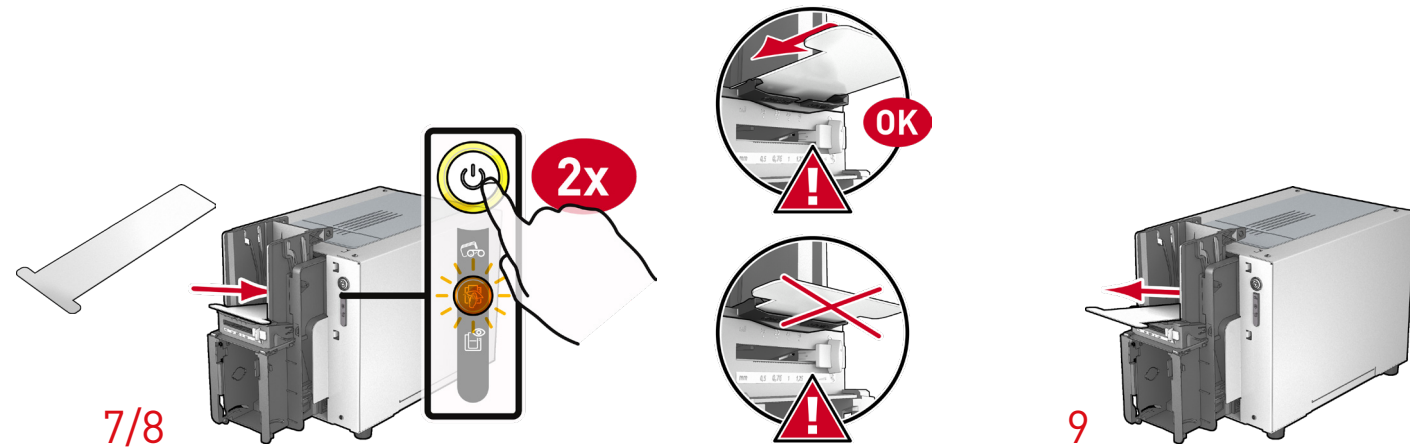
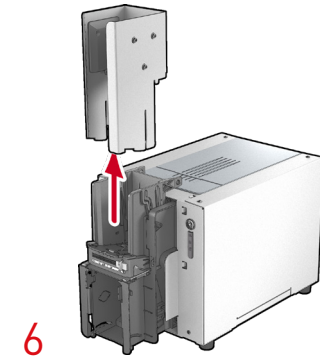
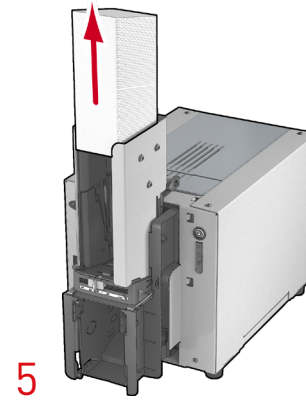
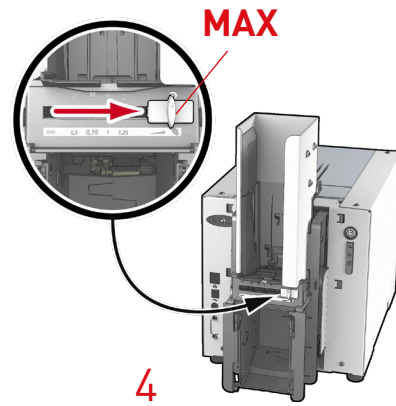

- 7 Double-click the control button before inserting the cleaning card.
- 8 Take the "T" shaped cleaning card and insert it in the feeder as shown. Cleaning starts.
- 9 Remove the "T" shaped card.



KC200
KC200B

- 10 Remove the film from the adhesive card (1) and insert the cleaning card into the feeder as shown, adhesive side up (2). Cleaning starts.
- 11 Remove the cleaning card.
- 12 Replace the cassette at feeder level.

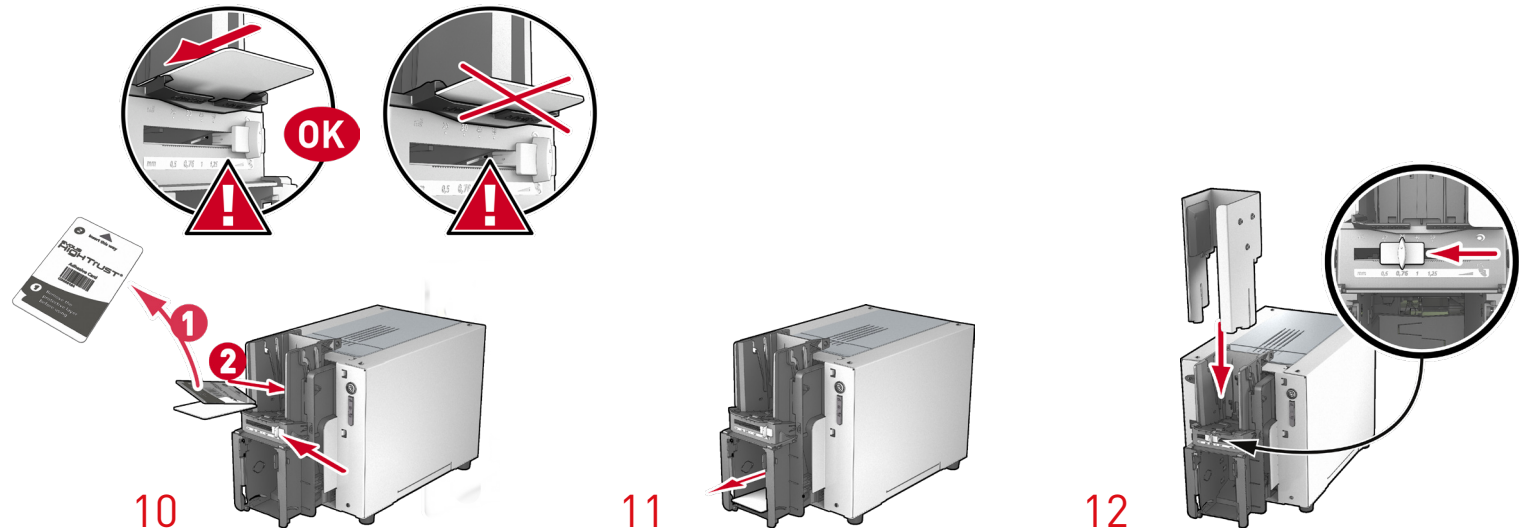

Advanced cleaning can also be launched from the Evolis Print Center by clicking on "Start cleaning."



Please note the "T" shaped card must be used immediately after the bag is opened.



Wait for 2 minutes after cleaning before using your printer. Don't forget to readjust the gauge to the desired card thickness.

If the terminal is in a dusty environment, we recommend that you place a protective cover on the printer to limit exposure to dust, whether the printer is in operational mode or not. For more thorough cleaning, you can also carry out advanced cleaning systematically instead of regular cleaning.

The cleaning frequencies recommended by Evolis may be increased depending on the environment in which the terminal is located.



KC200
KC200B

ROUTINE PRINTER CLEANING (SN<10000828147)

For printers with SN serial numbers less than 10000828147, please follow the cleaning procedure below.

Printer servicing



The print head warranty is directly linked to the periodic cleaning of your printer.
If you do not carry out this cleaning at the required times, the print head warranty will cease to be valid.



Recommended cleaning cycle: whenever the ribbon is changed
Mandatory cleaning cycle: when the cleaning warning is triggered
Servicing accessory: adhesive cleaning card.



Your printer is fitted with a cleaning warning system, which is triggered after a certain number of cards have been inserted.
You should proceed with the routine cleaning of your printer as soon as the warning is triggered.
If you continue to run the printer despite the warning and if the warning light remains lit, the print head warranty will be automatically voided because of failure to comply with contractual maintenance obligations.

Printer cleaning required after:
(warning light flashing)

1000 cards

Number of cards remaining before
warranty voided:

(warning light flashing)

200 cards

Warranty invalid after:
(warning light steady)

1200 cards



KC200
KC200B

Follow the procedure below to validate your routine cleaning:

Repeatedly passing the adhesive card through the printer cleans the cleaning roller in order to preserve print quality and increase the life of the print head.

- 1 Remove the weight and remove all cards from the feeder.
- 2 Remove the ribbon from the printer.
- 3 Set the card thickness gauge to MAX position.
- 4 Close the cover again.

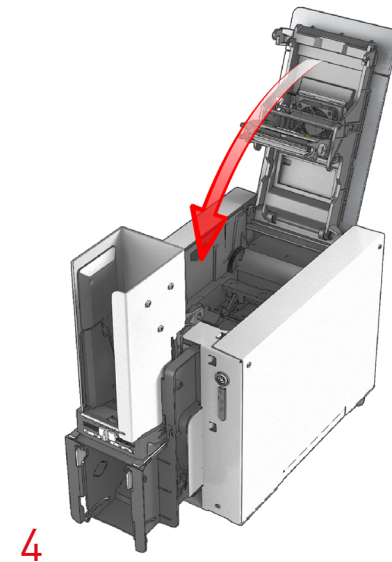
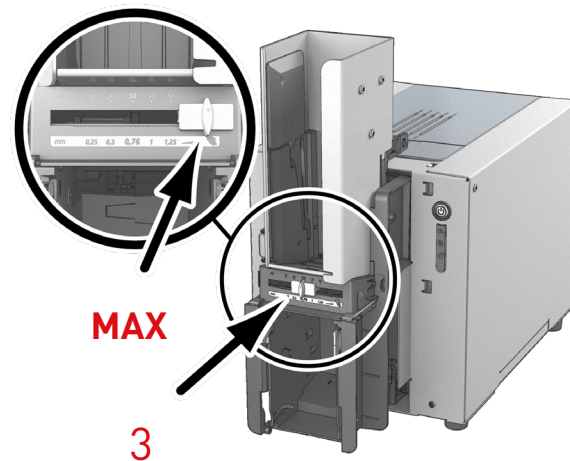
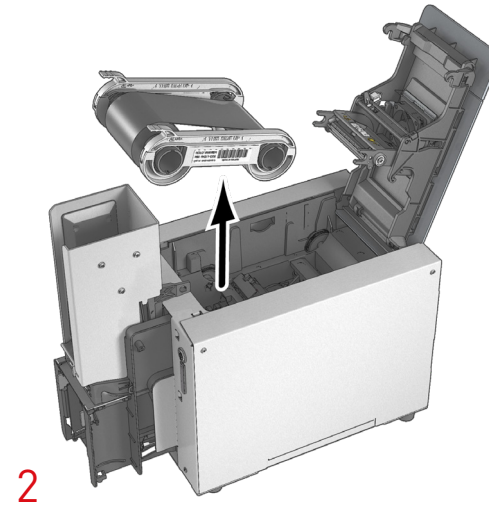
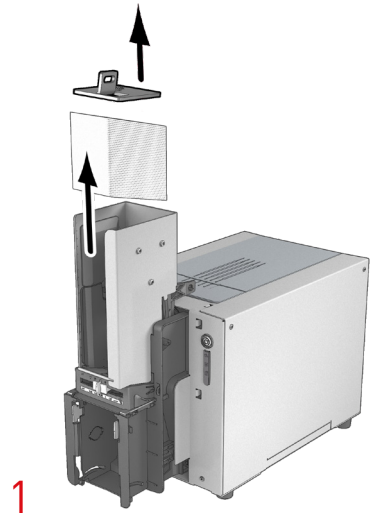



KC200
KC200B

- 5 Double-click the control button on the control panel before inserting the cleaning card.
- 6 Remove the film from the adhesive card (1) and insert the cleaning card into the feeder as shown, adhesive side up (2). Cleaning starts.
- 7 Remove the cleaning card.

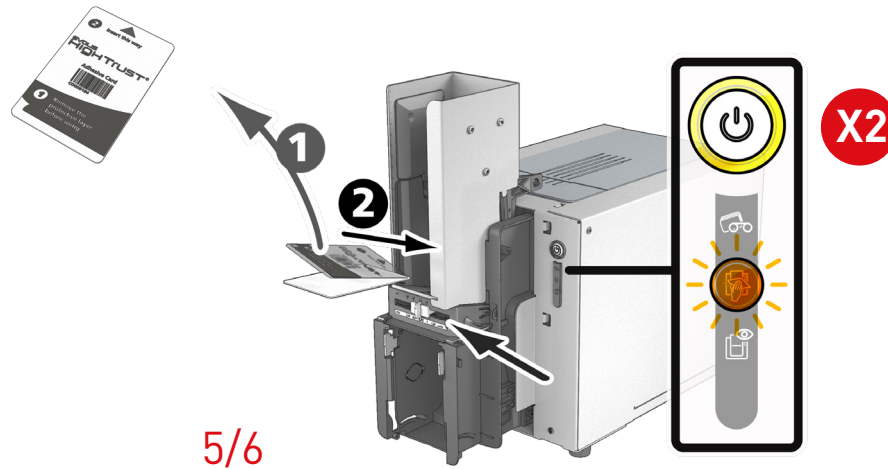

5/6



Routine cleaning may also be launched from the Evolis Print Center by clicking on "Start cleaning."



Before using your printer, remember to reset the gauge to the desired card thickness.



KC200
KC200B

Servicing of the print head



Recommended cleaning cycle: whenever the ribbon is changed.
Servicing accessory: special cotton swab impregnated with isopropyl alcohol or cleaning pen.

To maintain the original print quality and to absorb excess ink on the print head, we recommend that you clean the print head regularly (at each ribbon change and periodic cleaning) using the cotton swabs provided by Evolis. You must also protect the print head and its components from any electrostatic discharge.



Follow the cleaning cycles scrupulously.
Avoid any contact between the print head and any metal or sharp objects.
Avoid touching the print head directly with your fingers, as this could affect print quality or permanently damage the print head.

Follow the procedure below:

- 1 Take an Evolis cotton swab and press the middle of the tube until the end of the swab is soaked in alcohol.
- 2 Open the cover and locate the print head.
- 3 Gently rub the swab from left to right along the print head for a few seconds.
- 4 Close the cover.

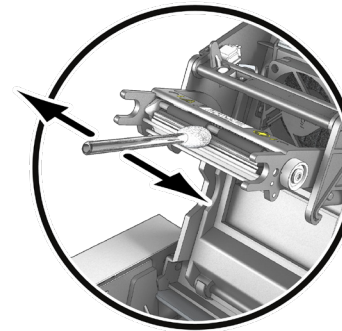

Wait for 2 minutes after cleaning before using your printer.



KC200
KC200B

ADVANCED CLEANING (SN<10000828147)

For even more thorough cleaning, we recommend advanced cleaning every 5 routine cleaning cycles.

To do this, Evolis provides an Evolis High Trust® maintenance kit consisting of 2 adhesive cards, 2 pre-soaked "T" shaped cards, a cleaning pen, and a box of wipes. The "T" shaped card is used to clean **the transport rollers and the head of the magnetic encoder**. To ensure advanced cleaning is carried out properly, the procedure given below must be followed.

Printer servicing



Recommended cleaning cycle: every 5 routine cleaning cycles.
Servicing accessory: pre-soaked "T" shaped card and adhesive card.

Follow the procedure below:

- 1 Open the printer cover.
- 2 Remove the ribbon.
- 3 Close the cover and check it has clicked shut.

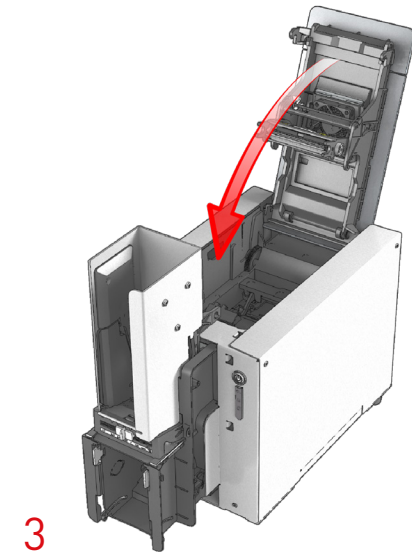
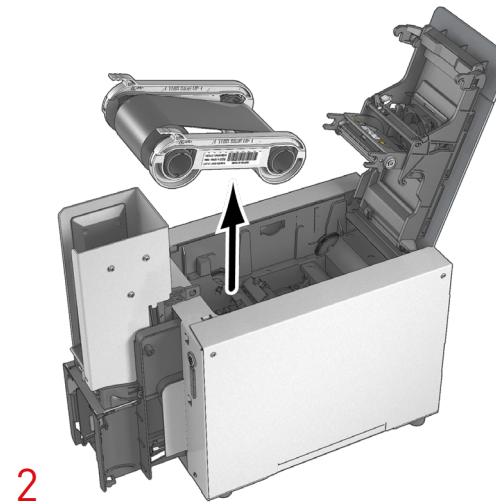
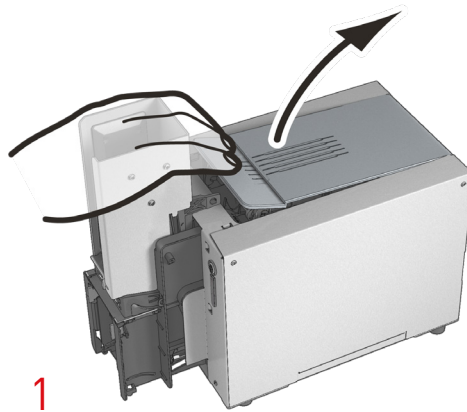



KC200
KC200B

- 4 Using the gauge, set the card thickness to the MAX position.
- 5 Remove the cards from the feeder if necessary.

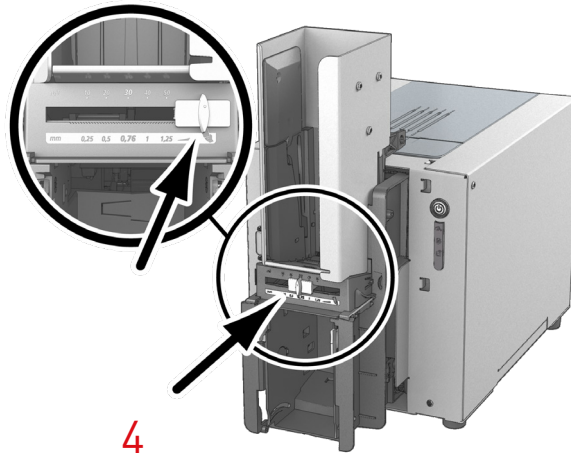

4

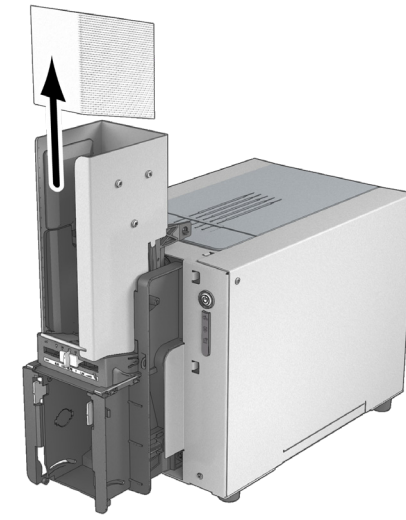

5

- 6 Double-click the control button before inserting the cleaning card.
- 7 Take the "T" shaped cleaning card and insert it in the feeder as shown. Cleaning starts.

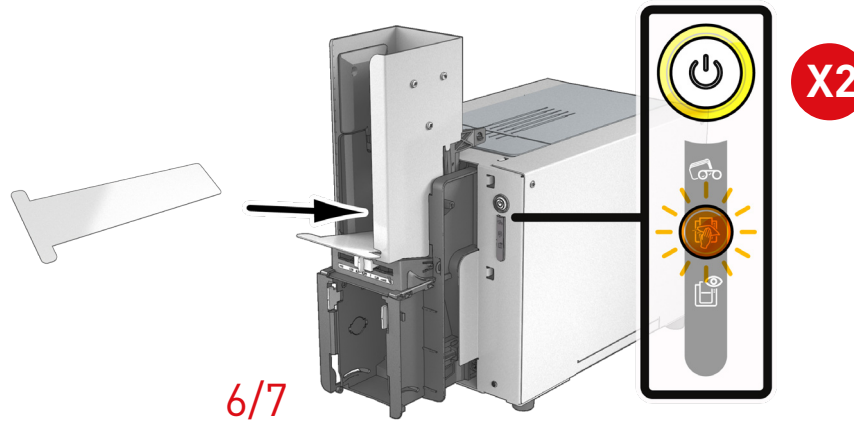

6/7



KC200
KC200B

- 8 Remove the "T" shaped card.
- 9 Remove the film from the adhesive card (1) and insert the cleaning card into the feeder as shown, adhesive side up (2). Cleaning starts.
- 10 Remove the cleaning card.

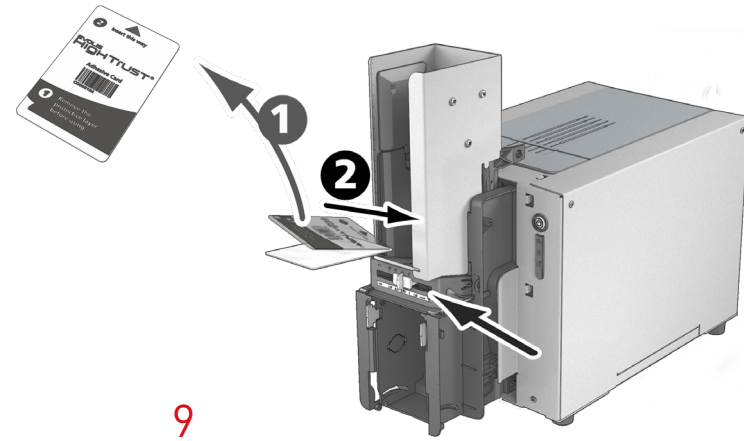
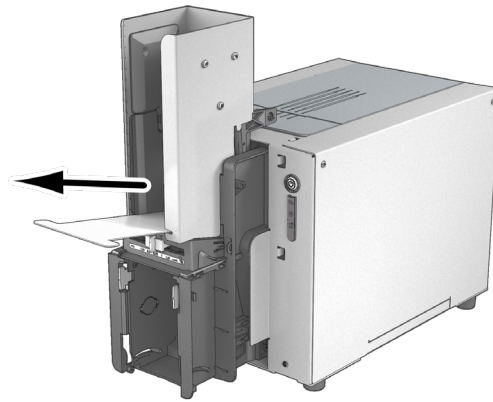

Advanced cleaning can also be launched from the Evolis Print Center by clicking on "Start cleaning."



Please note the "T" shaped card must be used immediately after the bag is opened.



Wait for 2 minutes after cleaning before using your printer. Don't forget to readjust the gauge to the desired card thickness.

If the terminal is in a dusty environment, we recommend that you place a protective cover on the printer to limit exposure to dust, whether the printer is in operational mode or not. For more thorough cleaning, you can also carry out advanced cleaning systematically instead of regular cleaning.

The cleaning frequencies recommended by Evolis may be increased depending on the environment in which the terminal is located.



KC200
KC200B

Maintenance of the dust filter (regardless of the printer serial number)

The dust filter is located above the ventilator for the print head. This filter can get dirty over time. We recommend cleaning it once a year or after 10,000 cards, depending on your work environment.

- 1 Open the printer cover. Locate the dust filter.
- 2 Remove the filter by pulling it up and sliding to release it completely.
- 3 Once the filter has been removed from its place, take one of the cleaning wipes supplied by Evolis.
- 4 Clean the filter by wiping each side of it.
- 5 To put it back, insert it in place (groove facing you) and push it down until it clicks into position.
- 6 Close the cover.

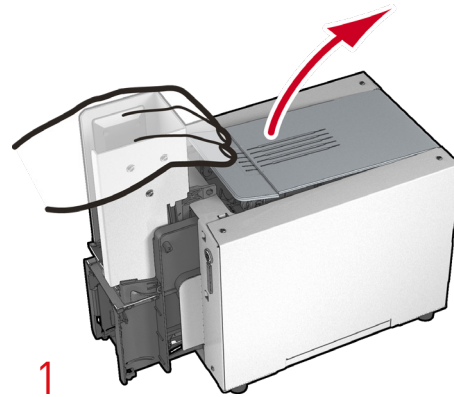

1

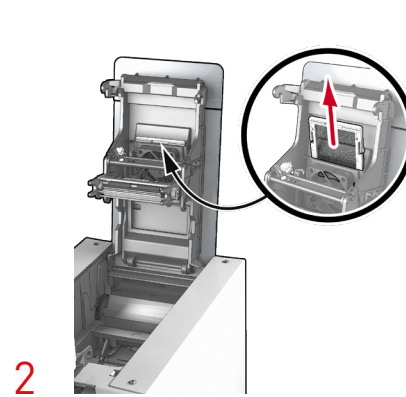

2



3

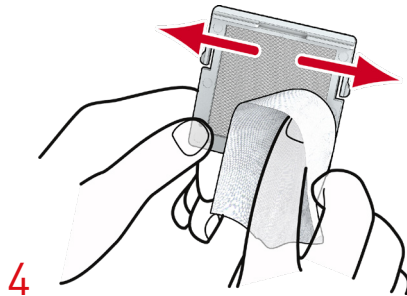

4



5

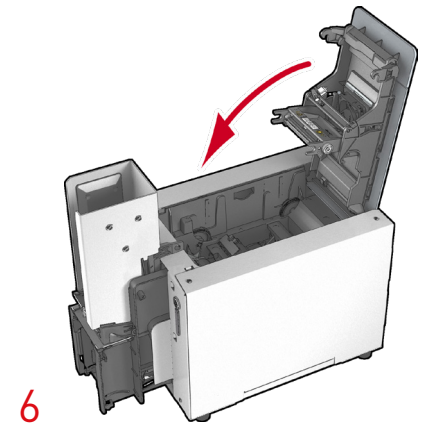

6



KC200
KC200B

APPLICATION DEVELOPMENT

We expressly recommend that you use the Premium SDK to develop the software application in a Windows environment.

The Premium SDK is designed for developers who want to communicate with one or several Evolis printers from their own software environment, while benefitting from the key functionalities of the Evolis Premium suite.

For other environments, other tools are available (SDK 2.5, etc.).



If other tools are used, for example SDK 2.5, the EPS must be installed in minimum mode, in order to avoid communication conflicts.

We strongly encourage you to use a single communication mode when designing a process.

Mixing communication modes may cause conflicts during communication with the printer, so it is important to be very careful: one communication mode is synchronous (communication via iomem.dll), whereas the other is asynchronous (communication via the print spooler).

If a combination of communication modes is used, synchronization between the application and the print spooler must take place.



Make sure that the pool of Evolis printers has the latest version of the firmware.



KC200
KC200B

APPENDIX A

TECHNICAL SPECIFICATIONS

This section presents your printer's technical printing properties.

General features

- Color sublimation directly on the card / resin thermal transfer
- Double-sided printing, edge-to-edge
- Standard resolution 300 x 300 dpi
- Resolution customizable to 300 x 600 dpi (monochrome and color printing) or 300 x 1200 dpi (monochrome printing only)
- 32 MB RAM

Print speed

Single-sided:

- Color (YMCKO) 20.5 s per card
- Monochrome 7 s per card

Double-sided:

- (YMCKO-K) 28 s per card

Card management and features

- Feeder capacity: 200 cards (0.76 mm – 30 mil) or 100 cards (0.76 mm – 30 mil) without metallic cassette
- Reject slots for faulty cards
- KC200: cards returned in the terminal output tray
- KC200B:
 - Manual insertion and return through the bezel
 - Capacity to recycle cards not collected
- Card thickness: 0.76 mm (30 mil)
- Card types: PVC cards, composite PVC cards, PET cards, ABS¹ cards, and special varnishes¹
- Card format: ISO CR80 – ISO 7810 (53.98 mm x 85.60 mm)

¹ In special conditions



KC200
KC200B

Ribbons

To maximize the quality and lifetime of the printed cards, the service life of the print head, and the overall reliability of your printer, use Evolis High Trust® ribbons.

- Ribbon capacity:
 - YMCKO 300 prints/roll
 - YMCKO-K 200 prints/roll
 - ½ YMCKO 400 prints/roll
 - KO 600 prints/roll
 - Monochrome black ribbon: 2000 prints/roll¹
 - Other monochrome ribbons: 1000 prints/roll¹
 - SO-KO 250 prints/roll
- Integrated ribbon saving for monochrome printing

¹ In special conditions

Ports/connectivity

- USB (1.0, 1.1, 2.0, 3.0)
- Ethernet TCP-IP, 10BaseT, 100BaseT (Traffic Led)

Display

- LEDs
- Graphical printer notifications: cleaning alerts, card feeder alert, and ribbon empty/almost empty

Software

- Compatible with Windows® (32/64 bits): XP SP3, Vista, W7, W8, W10
- Mac OS X (from 10.6)
- Linux available on request
- Evolis Premium Suite®:
 - Printer driver
 - Evolis Print Center for the administration and configuration of the printer
 - Evolis Printer Manager for visual notification²
 - 24/7 online support
- Free Evolis Premium SDK for monitoring the printer remotely, facilitating and accelerating integration with IT systems

² Requires .net 4.0 client profile



KC200
KC200B

Warranty conditions³

- 1 year of warranty (printer and print head)
- Optional extended warranty available

³ Warranty subject to strict compliance with specific usage and maintenance conditions and use of Evolis High Trust® ribbons

Dimensions and weight

- Dimensions (H x W x D):
 - KC200: 307 x 199 x 378 mm, with feet: H: 322 mm
 - KC200B: 307 x 199 x 399 mm, with feet: H: 322 mm
- Weight:
 - KC200: 5.6 kg
 - KC200B: 5.8 kg

Security

- Data encryption for magnetic encoding

Package contents

- Printer
- Power supply unit
- Mains power cable
- USB cable
- Installation, documentation, and software CD-ROM
- Starter cleaning kit
- Quick installation guide

Additional encoding modules

- Available modules:
 - ISO 7811 HiCo/LoCo, JIS2 magnetic strip encoder
 - Smartcard contact station ISO 7816-2
 - Contact smartcard encoder – PC/SC, EMV 2011-1
 - Contactless smartcard encoder – ISO 14443A, B, ISO 15693, MIFARE, DESFire, HID iCLASS, LEGIC
 - Other specific encoders on request
- Internal USB or IP connections
- Combinable options included



KC200
KC200B

Certifications and declarations of conformity

- Standby mode and reduced power consumption
- CE, FCC, ICES, VCCI, CCC, KC, EAC
- RoHS

Power supply

- Power supply unit: 100-240 volts AC, 50-60 Hz, 1.7 A
- Printer: 24 volts DC, 2.7 A

Environment

- Standard operating temperature and humidity:
 - 15 °C/30 °C (59 °F/86 °F)
 - 20% to 65% non-condensing
- Min/max operating temperature and humidity⁴:
 - 0 °C/40 °C (32 °F/104 °F)
 - 20% to 65% non-condensing
- Min/max storage temperature: -5 °C/+70 °C (23 °F/158 °F)
- Storage humidity: 20% to 70% non-condensing
- Ventilation while in operation: free air circulation

⁴ Under specific conditions and project qualification

The following icons appear on the printer label to indicate important information:



The equipment is evaluated at an altitude not exceeding 2,000 m; this is the only operating condition that applies to the equipment. There may be a potential safety risk if the equipment is used at an altitude above 2,000 m.



The equipment is evaluated in temperate climatic conditions; this is the only operating condition that applies to the equipment. There may be a potential safety risk if the equipment is used in a region with a tropical climate.



KC200
KC200B

APPENDIX B

DECLARATIONS OF CONFORMITY KC200

In this section, you will find the certifications for your Evolis printer.

Declarations of Conformity

Concerning the Safety and Electromagnetic Compatibility of Radio Equipment (Directives RED 2014/53/EU, LVD 2014/35/EU, EMC 2014/30/EU)

Manufacturer name: Evolis
Manufacturer address: 14, avenue de la Fontaine
Z.I. Angers Beaucouzé
49070 Beaucouzé, France

Equipment name: KC200
Year of manufacture: January 2019

I, the undersigned,
Mr. **Serge Olivier**,

Declare under my own responsibility that the product described above is in conformity with the essential applicable requirements of the following directives: **RED 2014/53/EU, LVD 2014/35/EU, EMC 2014/30/EU, and (RoHS2) 2011/65/EU:**

Article 3.1 a: [electromagnetic compatibility protection requirement]

Safety standard applied **EN60950-1: 2006 + A11 + A1 + A12 + A2**
EN50364: 2010

Article 3.1 b: [electromagnetic compatibility protection requirements]

EMC standard applied **EN55032: 2012**
EN55024: 2010
EN61000-3-2: 2014
EN61000-3-3: 2013
EN 301489-3: 2013 (V1.6.1.)



Article 3.2: [proper use of the radio spectrum to avoid harmful interference]

EMC standard applied **EN300 330-2 V1.6.1**

Full name: Serge Olivier
Title: R&D Director
Date: January 7, 2019
Signature:

EUROPE - Norway only: This product is designed for an IT power system with phase-to-phase voltage of 230 V. Earth grounding is via the polarized, 3-wire power cord.
FI: "Laite on liitettävä suojavaadoitus koskettimilla varustettuun pistorasiaan"
SE: "Apparaten skall anslutas till jordat uttag"
NO: "Apparatet må tilkoples jordet stikkontakt"
DK: "Apparatets stikprop skal tilsluttes en stikkontakt med jord, som giver forbindelse til stikproppens jord".

FCC Federal Communications Commission notice

Radio frequency interference in the United States



The KC200 model complies with the following specification:
FCC Part 15, Subpart A, Section 15.107(a) and Section 15.109(a)
Class B Digital device

Additional information:

This equipment has been tested and found to comply with the limits for a Class B digital device, pursuant to part 15 of the FCC Rules. These limits are designed to provide reasonable protection against harmful interference in a residential installation. This equipment generates, uses and can radiate radio frequency energy and, if not installed and used in accordance with the instructions, may cause harmful interference to radio communications. However, there is no guarantee that interference will not occur in a particular installation. If this equipment does cause harmful interference to radio or television reception, which can be determined by turning the equipment off and on, the user is encouraged to try the following measures:

- Reorient or relocate the receiving antenna.
- Move the equipment away from the radio or television.
- Connect the equipment to a circuit other than that to which the receiver is connected.
- Consult the supplier or an experienced radio/TV technician.

Use of a shielded twisted pair cable is necessary to comply with the restrictions laid down by part 15 of the FCC Rules for Class B digital devices.

Pursuant to Part 15.21 of the FCC Rules, any changes or modifications made to this equipment without the express, written consent of the company Evolis may cause harmful interference and void the FCC authorization to operate this equipment.

We recommend keeping a distance of 20 cm between the user and the RFID module when it is in operation. This device is compliant with the RSS of Industry Canada applicable to radio devices exempt from licensing. Its use is authorized under the following two conditions: (1) The device must not cause jamming and (2) the device user must accept any radio-electrical jamming it experiences, even if this compromises its operation.

Japanese radio frequency interference (VCCI)



This equipment is Class B information technology equipment based on the rules laid down by the Voluntary Control Council For Interference by Information Technology Equipment (VCCI). Its use in or close to a residential area may cause radio interference. If this occurs, you must take appropriate steps.

この装置は、情報処理装置等電波障害自主規制協議会（VCCI）の基準に基づくクラスB情報技術装置です。この装置は、家庭環境で使用することを目的としていますが、この装置がラジオやテレビジョン受信機に近接して使用されると、受信障害を引き起こすことがあります。
取扱説明書に従って正しい取り扱いをして下さい。



이 기기는 업무용(A급) 전자파적합기기로서 판매자 또는 사용자는 이 점을 주의하시기 바라며, 가정외의 지역에서 사용하는 것을 목적으로 합니다.



KC200
KC200B

DECLARATIONS OF CONFORMITY KC200B

In this section, you will find the certifications for your Evolis printer.

Declarations of Conformity

Concerning the Safety and Electromagnetic Compatibility of Radio Equipment (Directives RED 2014/53/EU, LVD 2014/35/EU, EMC 2014/30/EU)

Manufacturer name: Evolis
Manufacturer address: 14, avenue de la Fontaine
Z.I. Angers Beaucouzé
49070 Beaucouzé, France

Equipment name: KC200B
Year of manufacture: January 2019

I, the undersigned,
Mr. **Serge Olivier**,

Declare under my own responsibility that the product described above is in conformity with the essential applicable requirements of the following directives: **RED 2014/53/EU, LVD 2014/35/EU, EMC 2014/30/EU, and (RoHS2) 2011/65/EU:**

Article 3.1 a: [electromagnetic compatibility protection requirement]

Safety standard applied **EN60950-1: 2006 + A11 + A1 + A12 + A2**
EN50364: 2010

Article 3.1 b: [electromagnetic compatibility protection requirements]

EMC standard applied **EN55032: 2012**
EN55024: 2010
EN61000-3-2: 2014
EN61000-3-3: 2013
EN 301489-3: 2013 (V1.6.1.)



Article 3.2: [proper use of the radio spectrum to avoid harmful interference]

EMC standard applied **EN300 330-2 V1.6.1**

Full name: Serge Olivier
Title: R&D Director
Date: January 7, 2019
Signature:

EUROPE - Norway only: This product is designed for an IT power system with phase-to-phase voltage of 230 V. Earth grounding is via the polarized, 3-wire power cord.

FI: "Laite on liitettävä suojavaadoitus koskettimilla varustettuun pistorasiaan"

SE: "Apparaten skall anslutas till jordat uttag"

NO: "Apparatet må tilkoples jordet stikkontakt"

DK: "Apparatets stikprop skal tilsluttes en stikkontakt med jord, som giver forbindelse til stikproppens jord".

FCC Federal Communications Commission notice

Radio frequency interference in the United States



The KC200B model complies with the following specification:
FCC Part 15, Subpart A, Section 15.107(a) and Section 15.109(a)
Class B Digital device

Additional information:

This equipment has been tested and found to comply with the limits for a Class B digital device, pursuant to part 15 of the FCC Rules. These limits are designed to provide reasonable protection against harmful interference in a residential installation. This equipment generates, uses and can radiate radio frequency energy and, if not installed and used in accordance with the instructions, may cause harmful interference to radio communications. However, there is no guarantee that interference will not occur in a particular installation. If this equipment does cause harmful interference to radio or television reception, which can be determined by turning the equipment off and on, the user is encouraged to try the following measures:

- Reorient or relocate the receiving antenna.
- Move the equipment away from the radio or television.
- Connect the equipment to a circuit other than that to which the receiver is connected.
- Consult the supplier or an experienced radio/TV technician.

Use of a shielded twisted pair cable is necessary to comply with the restrictions laid down by part 15 of the FCC Rules for Class B digital devices.

Pursuant to Part 15.21 of the FCC Rules, any changes or modifications made to this equipment without the express, written consent of the company Evolis may cause harmful interference and void the FCC authorization to operate this equipment.

We recommend keeping a distance of 20 cm between the user and the RFID module when it is in operation. This device is compliant with the RSS of Industry Canada applicable to radio devices exempt from licensing. Its use is authorized under the following two conditions: (1) The device must not cause jamming and (2) the device user must accept any radio-electrical jamming it experiences, even if this compromises its operation.

Japanese radio frequency interference (VCCI)



This equipment is Class B information technology equipment based on the rules laid down by the Voluntary Control Council For Interference by Information Technology Equipment (VCCI). Its use in or close to a residential area may cause radio interference. If this occurs, you must take appropriate steps.

この装置は、情報処理装置等電波障害自主規制協議会（VCCI）の基準に基づくクラスB情報技術装置です。この装置は、家庭環境で使用することを目的としていますが、この装置がラジオやテレビジョン受信機に近接して使用されると、受信障害を引き起こすことがあります。
取扱説明書に従って正しい取り扱いをして下さい。



이 기기는 업무용(A급) 전자파적합기기로서 판매자 또는 사용자는 이 점을 주의하시기 바라며, 가정외의 지역에서 사용하는 것을 목적으로 합니다.