

LARGE FORMAT PRINTER SURECOLOR SC-T3270/T5270/T7270

EPSON
EXCEED YOUR VISION



NO MARGIN FOR ERROR? PRINT WITH PRECISION AND CONFIDENCE.

* Based on Max Quality 1440x1440dpi with High Speed On at 23°C, 50% RH on EPSON Singleweight Matte Paper

Developed with precision and consistency in mind, the Epson SureColor T-Series is engineered to produce precise and colourful prints consistently for every project. Using Epson's all-pigment UltraChrome™ XD ink and PrecisionCore™ printhead technology, you can be sure of conveying your ideas in the most detailed way possible.



Up to 44" Wide



Epson Genuine Inks



Cost Effective



Ethernet



Water Resistant



SureColor SC-T3270



SureColor SC-T5270/T7270

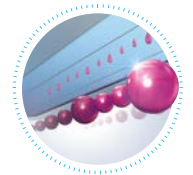

IT'S IN THE DETAILS.

With Epson UltraChrome™ ink, the SureColor T-series printers redefine consistent, quality printing.

Precision and Professional Output

The SureColor T-Series produces durable, quality prints. Print lines as thin as 0.02mm with a line accuracy of +/-0.1%, making it an ideal printer for CAD and 3D renderings.

Unparalleled Versatility

Print a wide range of applications with exceptional print quality, including architectural plans, maps, 3D rendering graphics, indoor signage and posters.

Exceptional Productivity Speed

Print documents at outstanding speeds of up to 2 A1 prints per minute.



Designed with the engineering profession in mind, the Epson SureColor T-Series ensures that you are empowered to print what you think with stunning quality and precision. Employing PrecisionCore technology, line placement is accurate to within +/- 0.1%, ensuring that your blueprints and graphics express what you really want them to.



Precision and Professional Output

Superior Precision and Quality

Utilising Epson's next-generation PrecisionCore printhead and Variable Size Dot Technology (VSDT), CAD documents and 3D architecture designs will be more accurate and colour consistent than ever before, with the industry-topping 10 nozzle lines* per printhead. Print precise lines as thin as 0.02mm with as little error as +/-0.1%, ensuring that you deliver your concept exactly how you want to. The PrecisionCore TFP printhead also removes the need for printhead replacements, avoiding the need to stock up on replacements, effectively providing you with a cost-effective printing solution.

*360 dpi per line

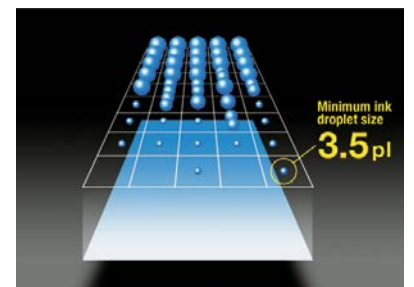
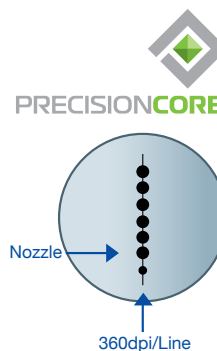

The combination of both technologies allow the ink droplets to be controlled to the finesse of 3.5 picolitres.

Remarkable Archivability

In industries that are constantly exposed to various types of environments, prints have to be durable enough to withstand elemental challenges. Epson's all-pigment UltraChrome XD ink has a higher ink penetration on paper, providing you with tested high lightfastness, rub and water-resistant prints, ensuring that your prints can go anywhere you need them to.

Experience extremely long-lasting prints with minimum aging effects*. The Epson UltraChrome XD ink also grants you an accurate reference of previous jobs, and cuts costs by exempting you from having to reprint documents for reference.

Print sample aging test on gloss paper	0 year	Light 52 years	Ozone Gas 50 years	Ozone Gas 60 years
EPSON UltraChrome XD Ink 				
Brand A (Dye Ink)				
Brand B (Dye Ink)				

*Light-and ozone-fastness is evaluated using the JEITA CP-3901 Digital Colour Photo Print Stability Evaluation test methodology. Test conditions for light-fastness are set to simulate indoor condition illuminated by sunlight through a glass window. Test conditions for ozone-fastness are set to simulate graphical deterioration from ozone gas in a standard home environment. Test results are indicative and for evaluation purposes only. Actual light-and ozone-fastness depends on prevailing storage and display conditions and are not guaranteed by the Seiko Epson Corporation.

Unparalleled Versatility

The Epson SureColor T-Series empowers you to produce a variety of prints with impeccable precision on a range of substrates, including 1.5mm thickboards. From architectural plans to maps and 3D renderings, print your required documents with confidence.



Indoor Signage



3D Rendering



CAD Drawing



GIS Map



Prints on 1.5mm media

With the add-on Epson T-Series MFP Scanner, you can expand the printer's application to include copying and scanning assorted media from newspapers to thickboard of up to 1.3mm.

Exceptional Productivity Speed

Print documents at outstanding speeds* of up to 2 A1 prints per minute for CAD documents, effectively assisting you in meeting deadlines and ensuring smooth business operations.

* Based on A1 plain paper printed via Speed mode.

POP

	Media	Resolution (dpi)	Print size	Print speed
 <p>Image size: A1:588x735mm *Size is based on Epson catalog</p>	Plain Paper	360 x 720	A1	28sec
		720 x 720	A1	66sec

CAD

	Media	Resolution (dpi)	Print size	Print speed
	Plain Paper	360 x 720	A1	30sec
		720 x 1440	A1	60sec

Unrivalled Accessibility

The Epson SureColor T-Series features front access for all operations, allowing you to place it against a wall to free up more floor space for your other needs. This enables you to change paper settings and ink cartridges, and to operate the printer's control panel, all from the front.



Paper Setting



Panel Operation



Change the Ink Cartridge

Easy to conform to paper and printer covers

MFP Scanner Option

MFP Scanner Option with swing function

High-Speed Auto Cutter

Spindle-less roll media handling

Basket

Large LED indicator



Stacker for single roll printers

2.7" Colour LCD

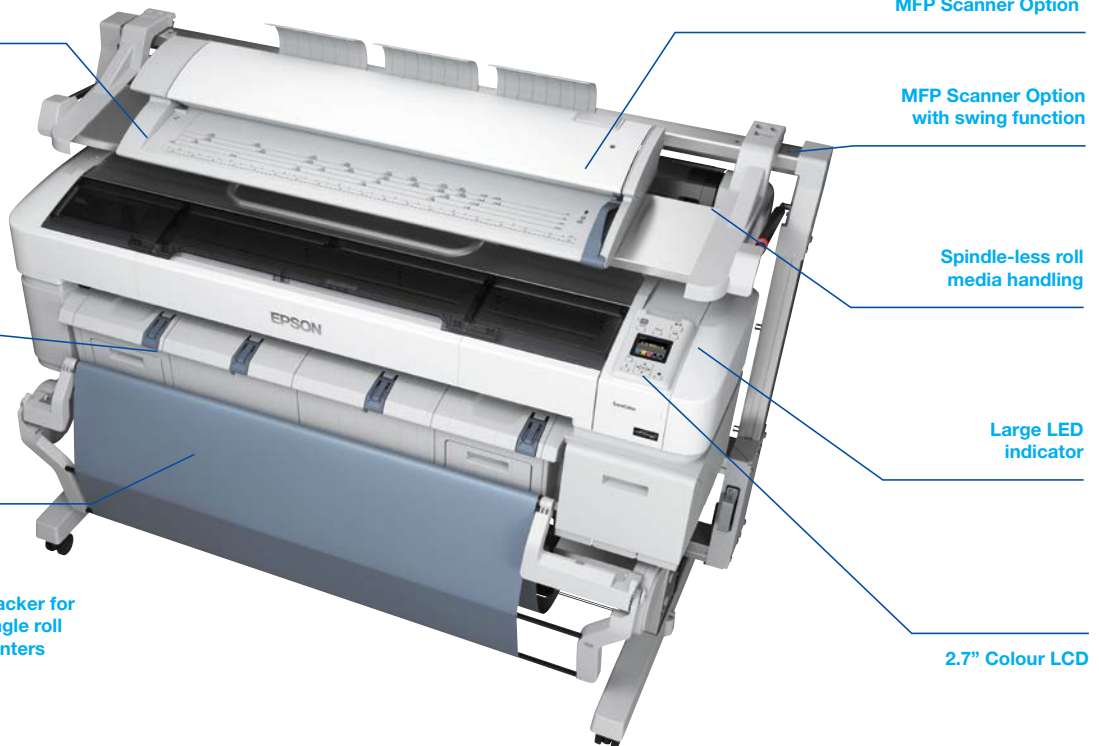

Economical and Cost-effective

Competitive cost-per-page and cartridges sizes from 110ml to 700ml to suit different printing volume needs.



110ml



350ml



700ml

Streamlined Productivity*

With the Epson T-Series scanner and HDD upgrade, you are able to scan and share over the network or via e-mail, and even store files directly into your document management system. These features effectively smoothen workflow and increase workplace productivity.

* Selected models only

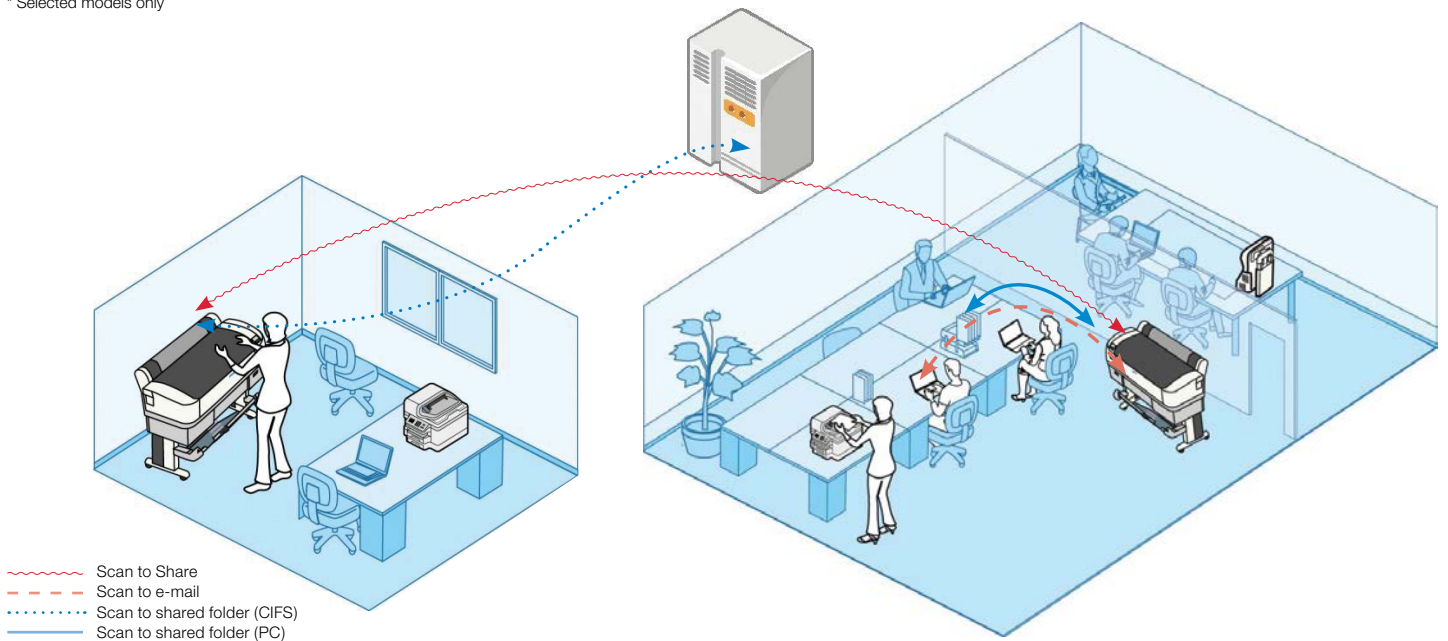



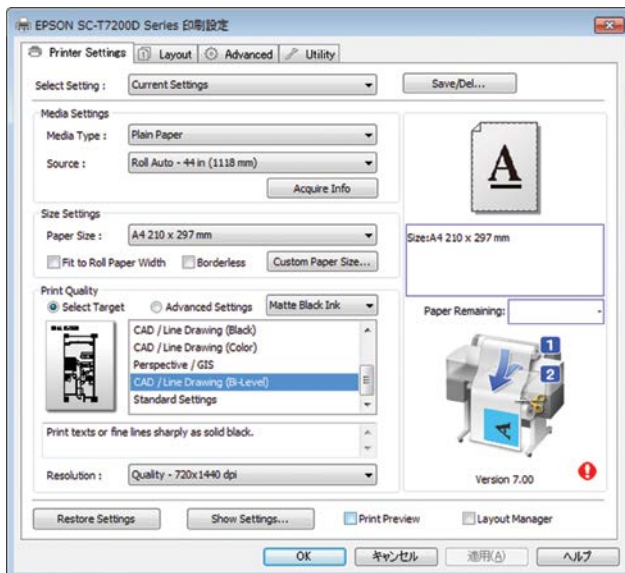



Minimise downtime and save paper with automatic dual roll media design - automatically switch between 2 rolls of media at will.



Comprehensive, Versatile Product Range

An extensive line up of printer configurations tailored to your individual business needs.

Printout Size		24" Width	36" Width	44" Width
SINGLE FUNCTION	SINGLE ROLL	 <p>24" Stand is available as an option only</p> <p>SC-T3270</p>	 <p>SC-T5270</p>	 <p>SC-T7270</p>
	DUAL ROLL		 <p>SC-T5270D</p>	 <p>SC-T7270D</p>
MULTI-FUNCTION PRINTER	DUAL ROLL <i>print scan copy</i>		 <p>SC-T5270D MFP</p>	 <p>SC-T7270D MFP</p>

The SureColor T-Series can be tailored to suit your business requirements. Epson understands that as your business grows, so do your needs. The SureColor T-Series features certain upgrades including:

Add-ons available	SC-T3270	SC-T5270	SC-T7270	SC-T5270D	SC-T7270D	SC-T5270DMFP	SC-T7270DMFP
Printer stand	X						
36" Scanner with stand		X	X	X	X		
Automatic take up reel			X				
320GB HDD*	X	X	X	X	X	X	X
Adobe PostScript 3 Expansion Unit (including 320GB HDD)*	X	X	X	X	X	X	X
Additional Roll media adapter	X	X	X	X	X	X	X

*All printers have only one slot available for either "320GB HDD" or "Adobe PostScript 3 Expansion Unit"

1. 320GB HDD

Enjoy greater productivity by adding the 320GB Internal Print Server to your printing line. Store up to 500 jobs on your SureColor T-Series for prompt printing without resending the data from a computer.

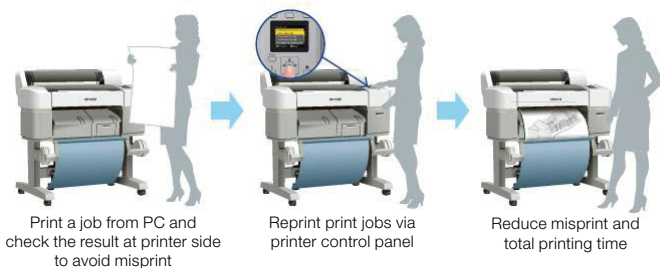
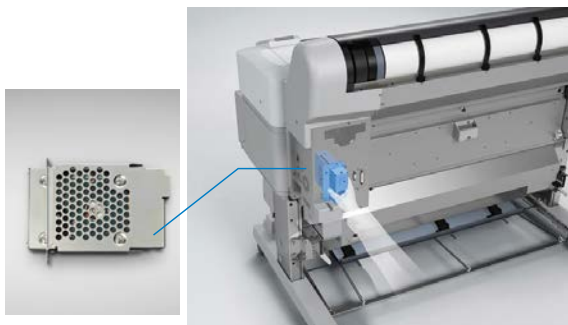

2. Adobe® PostScript® 3 Expansion Unit

Purchase Adobe PostScript 3 Expansion Unit to complement the Epson SureColor T-Series and be empowered to print directly with any Adobe software without the need for external drivers. Coupled with the 320GB Internal Print Server, the Adobe PostScript 3 Expansion Unit primes the T-series printer for maximum printing efficiency.

3. Automatic Take Up Reel**

Automate the collection of the finished printed product, allowing for continual printing of high volume print jobs.



** Available only for SC-T7270



4. Epson T-Series MFP Scanner

The 36" scanner provides you with a scanning feature for assorted media up to 1.3mm thick directly into your 320GB HDD. Be free to transfer the image to another SureColor T-Series printer, send it to a recipient via e-mail, or to store the image on your workspace shared folder or CIFS.



5. Additional Roll Media Adapter

The Additional Roll Media Adapter allows you to store an extra roll of substrate within the machine, giving you the option to mechanically switch between the two media samples to print on at will.

The Epson SureColor T-Series also uses a spindle-less roll holder that guarantees the operator's height will not hamper your work process, while making it easy to reload paper rapidly during peak periods.

		Single Function LFP					Multifunction LFP		
Model Name		SC-T3270	SC-T5270	SC-T7270	SC-T5270D	SC-T7270D	SC-T5270DMFP	SC-T7270DMFP	
Printer Width & Type		24" Single Roll (without stand)	36" Single Roll	44" Single Roll	36" Dual Roll	44" Dual Roll	36" Dual Roll	44" Dual Roll	
Print	Technology	PrecisionCore TFP Printhead with Variable-Sized Droplet Technology							
	Nozzle Configuration	720 nozzles each colour (x5)							
	Maximum Resolution	2880x1440 dpi							
	Minimum Ink Droplet Volume	3.5pl							
	Poster / CAD Plain Paper Speed A1(Long Edge First)	Approx. 28 sec / A1 Speed mode (w/cut)							
	Line Accuracy	+/-0.1% Based on Max Quality 1440x1440dpi with High Speed On at 23°C, 50% RH on EPSON Singleweight Matte Paper							
	Minimum Line Width	0.02mm							
	Ink System	Types	Epson UltraChrome XD All Pigment Ink						
		Colours	Cyan, Magenta, Yellow, Photo Black, Matte Black						
		Capacity	110ml / 350ml / 700ml						
Paper Handling		Single top-loading roll feed, Manual top-loading sheet fed, Manual front-loading thick board feed			Two automatic roll feeds (top- and front-loading), Manual top-loading sheet fed, Manual front-loading thick board feed		Two automatic roll feeds (top- and front-loading), Manual top-loading sheet fed, Manual front-loading thick board feed		
Paper Size	Rolls (0.08mm - 0.5mm thickness; max roll diameter 150mm)	254 - 610mm width	254 - 914mm width	254 - 1,118mm width	254 - 914mm width	254 - 1,118mm width	254 - 914mm width	254 - 1,118mm width	
	Sheets (0.08mm - 0.8mm thickness)	210 - 610mm width	210 - 914mm width	210 - 1,118mm width	210 - 914mm width	210 - 1,118mm width	210 - 914mm width	210 - 1,118mm width	
	Thick Board	0.8 - 1.5mm thickness							
Borderless Printing		Available							
Scan	Scan Speed						Colour/Grayscale: Up to 8.4cm/sec (3.3inch/sec)		
	Scan / Copy Resolution						Up to 600 dpi		
	Scan Sizes						Width: 153 to 914.4mm (6 to 36inches); Length: 153 to 2438.4mm (6 to 96inches); Thickness: 0.05 to 1.3mm		
	Features						Scan to Folder, Scan to Mail, Scan to HDD, Scan to Share*		
Copy	Copy Speed						Up to 39 sec (A1 size, 300 dpi colour copy)		
	Reduction / Enlargement						25 to 400%		
	Maximum Copies						Up to 99 copies		
	Copier Settings						Quality, Density, Contrast, Remove Background, Sharpness, Document Type (5 types)		
Control Panel	2.7 inch Colour LCD								
Memory	Standard	1GB RAM (Expandable to 5GB RAM with Adobe® PostScript® 3™ Expansion Unit)							
	Hard Disk	Optional 320GB					320GB**		
Connectivity	Interfaces (Standard)	Hi-Speed USB, 10BASE-T/100BASE-TX / 1000BASE-T							
	Print Languages (Standard)	ESC/P raster, HP-GL/2, HP RTL							
	Print Languages (Optional)	Adobe PostScript® 3, Adobe PDF 1.7, PS, PDF, TIFF, JPEG, CALS-G4 (Type 1), EPS (via Adobe® PostScript® 3™ Expansion Unit)							
	Drivers Included	Windows XP / Vista / 7 / 8 / 8.1 (32/64bit) / Mac OS X 10.5.8 or later Windows Server 2003 Standard / Standard *64bit, 2008 Standard / Standard *64bit / R2, 2012 or later (Certification / Logo : Windows Server 2008 / 2008R2)							
Security	Network Security	Access Control, IPsec, IEEE802.1X, HTTPS							
	HDD Sanitizing HDD	DoD5220.22-M Compliant Sanitizing ¹ Fast Sanitizing ² ¹ It takes approx. 21h ² It takes approx 2h							
Software	Standard (Bundled)	LFP Print Plug-In for Office, EPSON LFP Remote Panel 2, EpsonNet Config, EpsonNet Print (Windows only)							
	Option (Web Download)	Epson LFP HDD Utility, LFP Accounting Tool							
Recommended System Requirements		PC: Windows 10 / 8.1 / 8 / 7 / Vista / XP; Core 2 Duo 3.05GHz, Memory more than 1GB, HDD Free Space more than 32GB Macintosh Mac OS X (10.5.8 or later); Core 2 Duo 3.05GHz, Memory more than 1GB, HDD Free Space more than 32GB							

Dimensions and Weight

SureColor SC-T3270
Weight: Approx 54kg (119lb) without stand
Approx 67kg (147.7lb) with stand
Dimension: 1,050mm x 691mm x 613mm (without stand)



SureColor SC-T5270/T5270D
Weight: Approx 84kg (185.2lb) Single Roll
Approx 118kg (260.2lb) Dual Roll

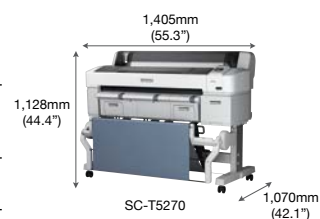

SureColor SC-T7270/T7270D
Weight: Approx 92kg (202.8lb) Single Roll
Approx 133kg (293.2lb) Dual Roll



* Feature allows transfer of images between Epson T-series Multifunction Printers.

** Multifunction LFP requires either 320GB Hard Disk Unit or Adobe Post Script Expansion Unit with 320GB HDD.

		Single Function LFP					Multifunction LFP		
Model Name		SC-T3270	SC-T5270	SC-T7270	SC-T5270D	SC-T7270D	SC-T5270DMFP	SC-T7270DMFP	
Printer Width & Type		24" Single Roll (without stand)	36" Single Roll	44" Single Roll	36" Dual Roll	44" Dual Roll	36" Dual Roll	44" Dual Roll	
Power Requirements	Power Requirements	Input voltage AC 100-240V 50/60Hz / 1.0A-0.5A							
	Power Consumption (Printer)	Operating	Approx. 52 W	Approx. 60 W	Approx. 64 W	Approx. 61 W	Approx. 65 W	Approx. 61 W	Approx. 65 W
		Ready	Approx. 16 W	Approx. 16 W	Approx. 16 W	Approx. 17 W	Approx. 17 W	Approx. 17 W	Approx. 17 W
		Sleep	Approx. 3.0 W						
		Power Off (Stand-By)	Less than 0.5 W						
	Recommended Operating Temperature & Humidity	10 - 35°C; 20 - 80% RH (non-condensing)							
Recommended Storage Temperature & Humidity	-20 - 40°C; 5 - 85% RH (non-condensing)								
Acoustic Sound Pressure	Approx. 50dB(A) (operating) / Approx. 31dB(A) (Sleep)								
Acoustic Sound Power	Approx. 6.8B(A) (operating)								
Dimensions / Weight	Dimension (WxDxH)	1,050mm x 691mm x 613mm / 1,050mm x 1,070mm x 1,117mm (w/ Stand)	1,405mm x 1,070mm x 1,128mm	1,608mm x 1,070mm x 1,128mm	1,405mm x 1,070mm x 1,128mm	1,608mm x 1,070mm x 1,128mm	1,539mm x 1,074mm x 1,321mm	1,742mm x 1,074mm x 1,321mm	
	Weight (Without Ink Cartridges)	Approx. 54kg / 67kg (w/ Stand)	Approx. 84kg	Approx. 92kg	Approx. 118kg	Approx. 133kg	Approx. 168kg	Approx. 184kg	
Options	Hard Disk Unit - 320GB Internal Print Server	C12C848031							
	Hardware RIP Software	Adobe® PostScript® 3™ Expansion Unit (Hardware RIP with 320GB HDD)							
	Printer Stand	C12C844171							
	Mfp Scanner	C12C891071							
	Mfp Scanner Stand	C12C844151	C12C844161	C12C844151	C12C844161				
	Automatic Take-Up Reel Unit & Attachment		C12C815321 & C12C815411						
	Additional Roll Media Adapter	C12C811401							
Consumables	Photo Black Ink Cartridge	C13T692100 (110ml) / C13T693100 (350ml) / C13T694100 (700ml)							
	Cyan Ink Cartridge	C13T692200 (110ml) / C13T693200 (350ml) / C13T694200 (700ml)							
	Magenta Ink Cartridge	C13T692300 (110ml) / C13T693300 (350ml) / C13T694300 (700ml)							
	Yellow Ink Cartridge	C13T692400 (110ml) / C13T693400 (350ml) / C13T694400 (700ml)							
	Matte Black Ink Cartridge	C13T692500 (110ml) / C13T693500 (350ml) / C13T694500 (700ml)							
	Replacement Ink Maintenance Box	C13T619300							
	Replacement Printer Cutter Blade	C13S902007							

Dimensions and Weight

SureColor SC-T5270D Multi Function Printer
Weight: Approx 168kg (370.3lb) Dual Roll

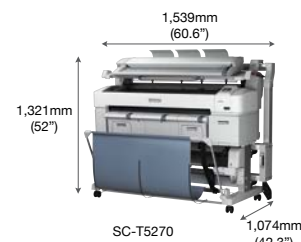

SureColor SC-T7270D Multi Function Printer
Weight: Approx 184kg (405.7lb) Dual Roll



© 2019 Epson Singapore Pte Ltd. All Rights Reserved. Reproduction in part or in whole, without the written permission from Epson, is strictly prohibited. EPSON and EXCEED YOUR VISION are registered trademarks of Seiko Epson Corporation. All other products names and other company names used herein are for identification purposes only and are the trademarks or registered trademarks of their respective owners. Epson disclaims any and all rights in those marks. Print samples shown are simulations only. Specifications and product availability are subject to change without notice and may vary between countries. Please check with local Epson offices for more information.

Information correct as at August 2019