

## STD-AUTO-G040

### Installation and Utilization Instructions

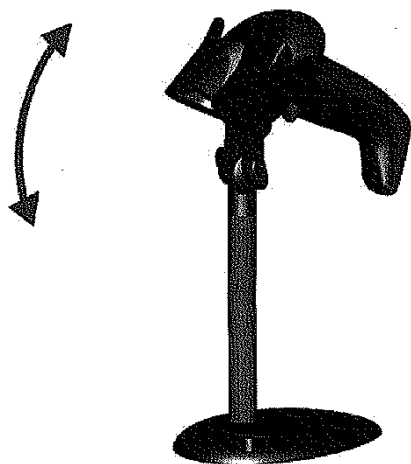

Figure 1

### GENERAL FEATURES

The STD-AUTO-G040 is a stand for the Gryphon™ barcode readers for hands-free operation. It also provides that the reader's handle is always within the operator's reach.

The mounting kit supplied with the stand contains the following components:

- 3 self-tapping screws
- 2 adhesive strips

### UTILISATION

Insert the reader head into the stand as shown at left in Figure 1.

Position the reader for the best orientation with respect to the barcodes to read. It is possible to get a better reading position by rotating the reader support in the direction of the arrows shown in Figure 1.

### ASSEMBLING THE STD-AUTO-G040

To assemble the STD-AUTO-G040 proceed as follows, referring to Figure 2:

1. Connect the left and right supports with the magnet ①, then fix them to the central support ② with the positioning screw ③ and the washers ④ (optional).



**For easier insertion of the reader, install the washers. To increase grip between the reader and the stand, install without the washers.**

2. Position the assembly by screwing the central support ② into the tube ①.
3. Position the assembly onto the base by fixing the tube ① with the fixing screw ④.

The reader-holder position can be adapted to each reader by loosening the positioning screw ③, repositioning the reader support, and tightening the positioning screw ③.

### FIXED DESKTOP USE

The STD-AUTO-G040 can be mounted to any surface using either the 3 self-tapping screws, or by using the 2 double-sided adhesive strips.

Refer to Figure 2 while proceeding as follows:



### Mounting with screws:

1. Be sure that the STD-AUTO-G040 is already assembled.
2. Fix the STD-AUTO-G040 base to the desired surface by means of the three self-tapping screws.

### Mounting with adhesive strips:

1. Carefully clean bottom surface of the holder with alcohol to remove any impurities that could reduce the adhesion.
2. Remove the protective plastic from one side of the adhesive strips and stick them onto the bottom surface of the holder.
3. Remove the plastic from the other side of the strips and affix the STD-AUTO-G040 to the surface, as shown in Figure 2.



**The surface must be smooth and clean to allow correct adhesion.**

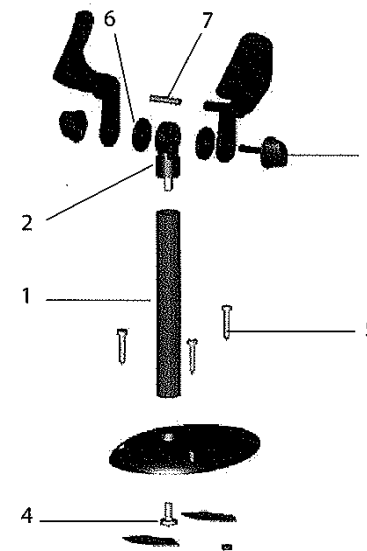

Figure 2